



LIAN LI

Feel the difference

O11 DYNAMIC

Installation Guide / 安裝說明書
Guide d'installation / Montageanleitung
Guía de instalación / インストールガイド

- * Case components * Composants du boîtier * Guía de instalación
 * 機殻部品紹介 * Gehäusekomponenten * ケース各部紹介



- (A) Power switch / 電源開關按鍵 / 電源スイッチ

 (B) Multi-media ports (USB 3.0 x 2, USB 3.1 Type-C, HD audio) / 多媒體連接埠 / マルチメディアI/Oポート

 (C) Spare 120 mm fans x 3 or 140 mm fans x 2 / 預留 120 mm風扇 x 3 或 140 mm 風扇 x 2
 追加120 mm ファン x 3 または140 mm ファン x 2

 (D) PCI slots with ventilation / PCI 通風擋片 / 通気構造のPCIスロット

 (E) 2.5" HDD x 2 / 2.5吋硬碟 x 2 / 2.5" HDDマウントスペース x 2

 (F) Removable HDD tray (3.5" HDD x 2 or 2.5" HDD x 2 or PSU x 1) / 可拆硬碟托盤 / リムーバブルHDDトレイ

 (G) Removable HDD tray (3.5" HDD x 1 + 2.5" HDD x 1 or 2.5" HDD x 2) /
 可拆硬碟托盤 / リムーバブルHDDトレイ

 (H) PSU tray / 電源供應器裝置槽 / 電源ユニット固定ステー

 (I) Spare 120 mm fans x 3 / 預留 120 mm 風扇 x 3 / 追加120 mm ファン x 3

 (J) Spare 120 mm fans x 3 / 預留 120 mm 風扇 x 3 / 追加120 mm ファン x 3

*** Hardware list**
*** 零件盒部品一覽表**

*** Liste des pièces**
*** Hardwareliste**

*** Lista de materiales**
*** 付属品一覽**

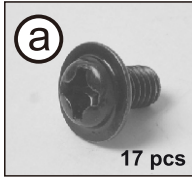

Screws
for mother board &
2.5" HDD mount

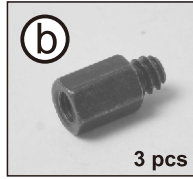

Stand off bolt (Spare parts)
for Motherboard Mount

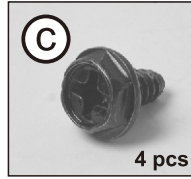

Screws for PSU Mounting

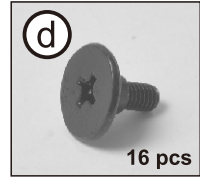

Screws
for 2.5" HDD

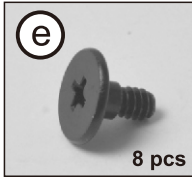

Screws
for 3.5" HDD

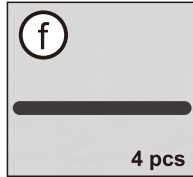

Velcro
for cable management

- ※ Exceeded quantity are spare parts.
- ※ 多餘的零件數量是備品。
- ※ Les pièces supplémentaires sont des pièces de rechange.
- ※ Zusätzliche Teile können als Ersatzteile verwendet werden.
- ※ Exceeded quantity are spare parts.
- ※ ネジには予備が含まれてれています。

- * Remove top panel**
- * 卸下頂部面板**
- * Retirer le panneau supérieur**
- * Entfernen Sie die obere Abdeckung**
- * Retire el panel superior**
- * トップパネルを取り外す**

- * Remove side panel**
- * 卸下側板**
- * Retirer le panneau latéral**
- * Seitenverkleidung entfernen**
- * Retire el panel lateral**
- * サイドパネルを取り外す**

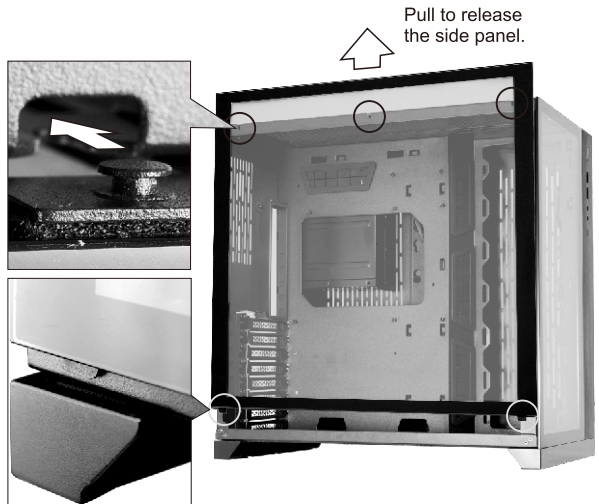

- * PSU installation
- * 電源供應器安裝
- * Installation du plateau du bloc d'alimentation

- * PSU-Einsatz installieren
- * Instalación de la fuente de alimentación
- * 電源ユニットの取り付け

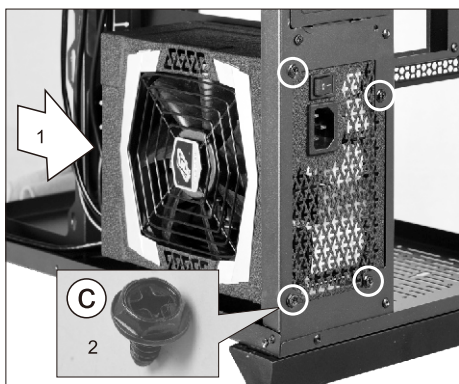
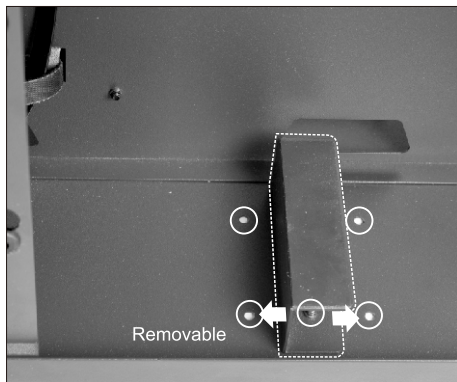
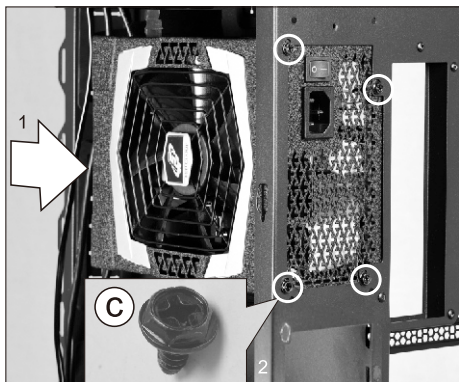
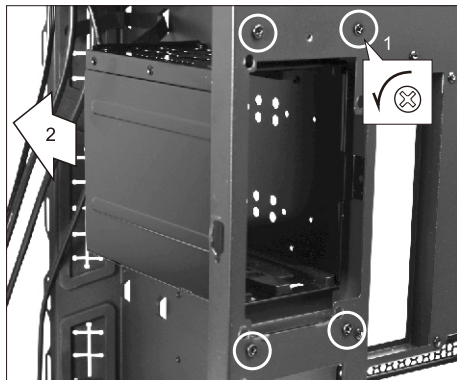
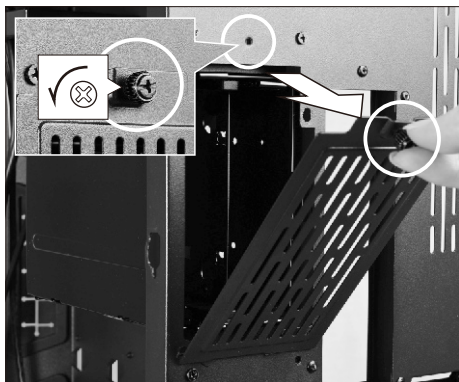

- * Motherboard installation
- * 主機板安裝
- * Installation de la carte mère
- * Motherboard installieren
- * Instalación de la placa base
- * マザーボードの取り付け

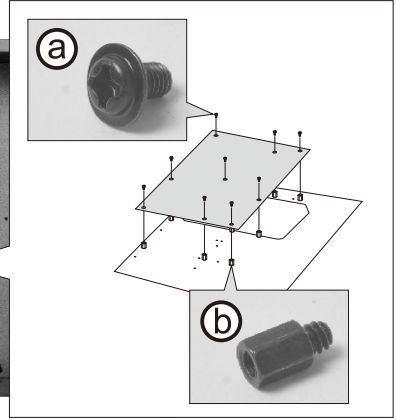
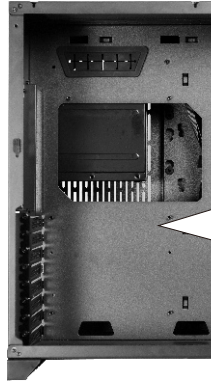

- * 2.5"/3.5" HDD installation
- * 2.5/3.5吋硬碟安裝
- * Installation d'un DD2.5"/3.5"

- * 2.5/3.5-Zoll-Festplatte installieren
- * Instalación de unidad de disco duro de 2.5"/3.5"
- * 2.5"/3.5" ハードディスクの取り付け

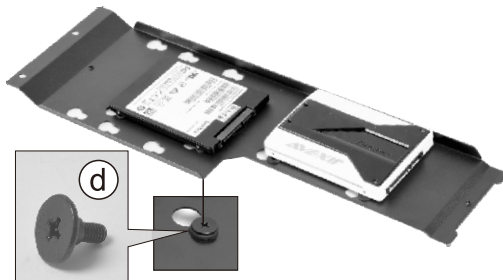
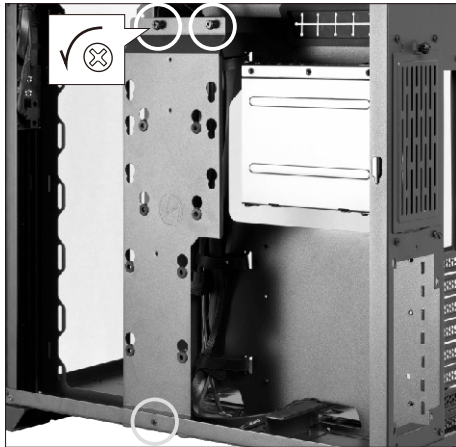

- * 2.5"/3.5" HDD installation
- * 2.5/3.5吋硬碟安裝
- * Installation d'un DD 2.5"/3.5"

- * 2.5/3.5-Zoll-Festplatte installieren
- * Instalación de unidad de disco duro de 2.5"/3.5"
- * 2.5"/3.5" ハードディスクの取り付け

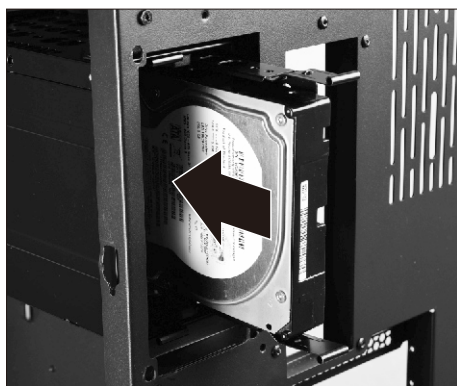
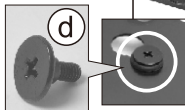
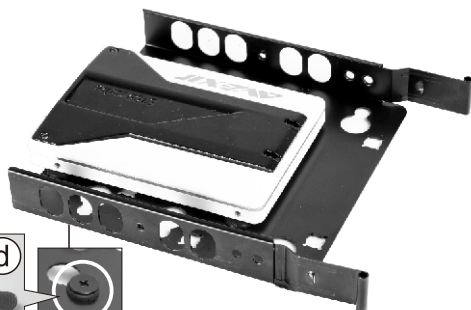
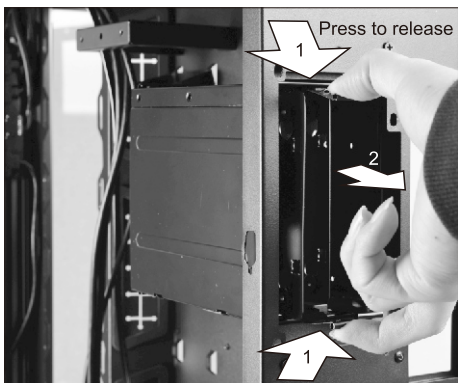
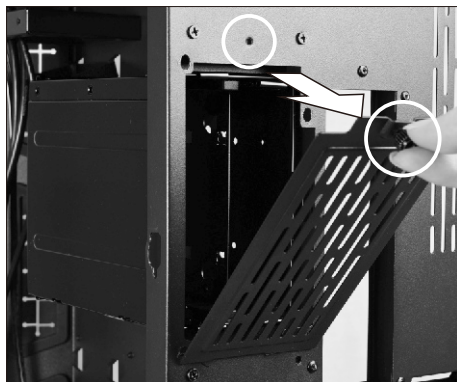

- * 2.5" HDD installation
- * 2.5吋硬碟安裝
- * Installation d'un DD 2.5"
- * 2.5-Zoll-Festplatte installieren
- * Instalación de unidad de disco duro de 2.5"
- * 2.5"ハードディスクの取り付け

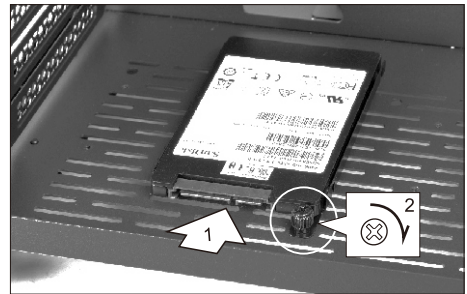
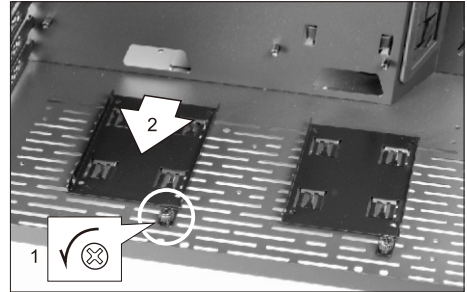
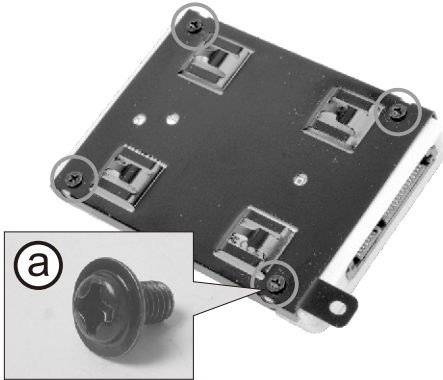

- * Remove air filters
- * 空氣濾網拆卸
- * Retirez les filtres à air
- * Entfernen Sie Luftfilter
- * Retire los filtros de aire
- * エアフィルターの取り外し

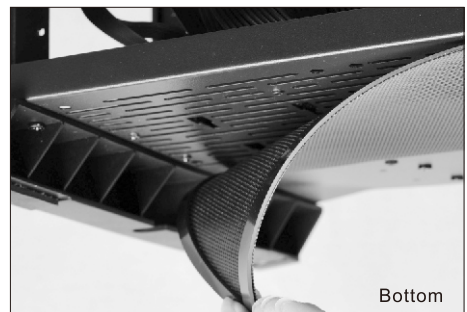
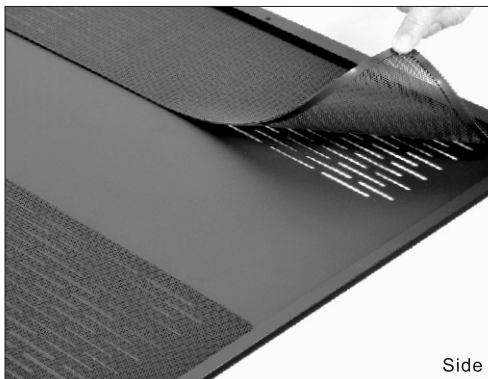
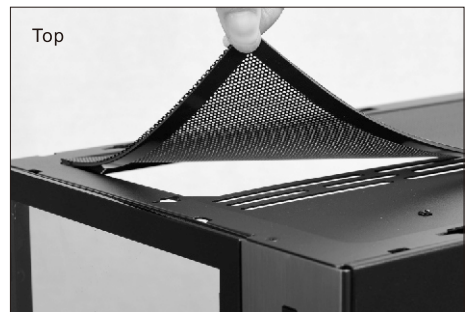

* Hardware clearance

* 硬體擴充支援

- CPU air cooler
- GPU
- PSU with bracket
- PSU without bracket
- Radiator clearance

* Passage de matériel

* Hardware-Freigabe

* Limpieza de hardware

* ハードウェア拡張のサポート

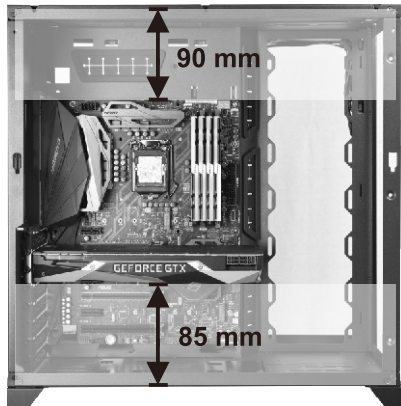
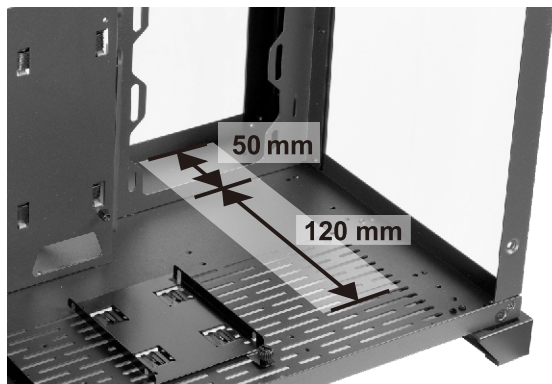
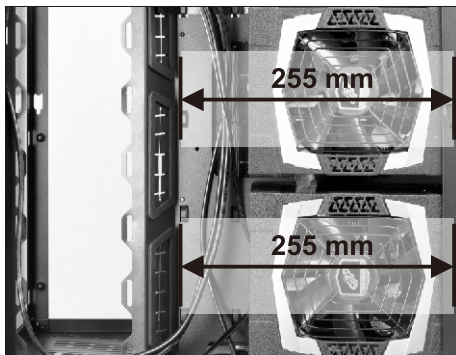
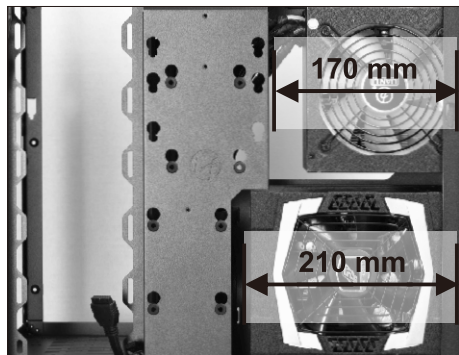
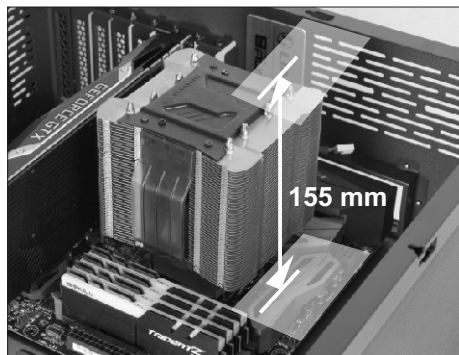

Option kits / 選配套件
Kits optionnels / Optionale Sets
Kits opcionales / オプションパーツ

Upright display card Kits
 (200 mm PCI-e Express 16X Riser Card Adapter
 Extender Cable Kit)

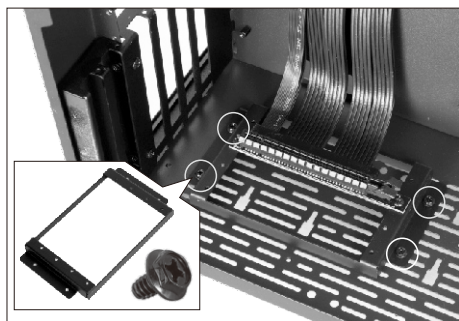
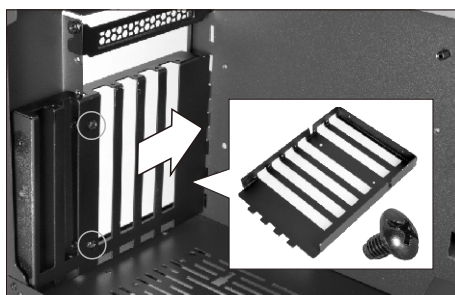
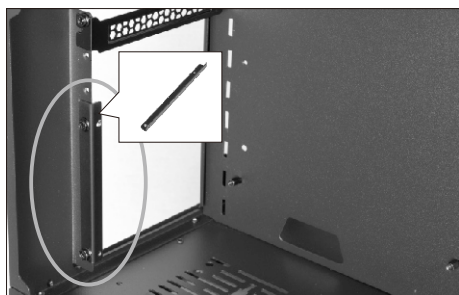
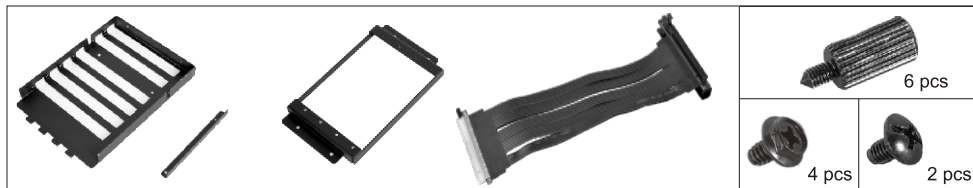

- * I/O port installation
- * USB 3.0 / HD Audio 接続定義
- * Installation du port E/S
- * I/O-Port installieren
- * Instalación de los puertos de E/S
- * I/O ポートに関して

USB 3.0 Supports motherboard
 USB 3.0 20 Pin header

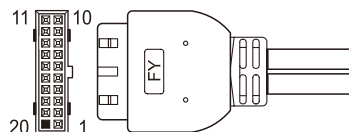

HD AUDIO

- | | | | |
|--------------|----|---|---------------|
| Blue | 10 | 9 | Green |
| Black purple | 8 | 7 | Key |
| Yellow | 6 | 5 | Orange |
| Gray | 4 | 3 | N.C. |
| Red | 2 | 1 | GND+H.S. TUBE |

