

REV	DESCRIPTION OF CHANGE	DATE

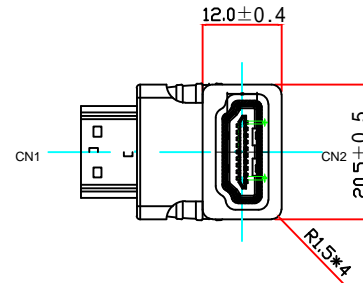
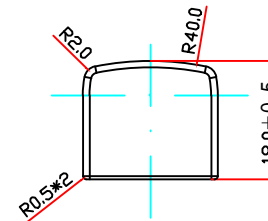
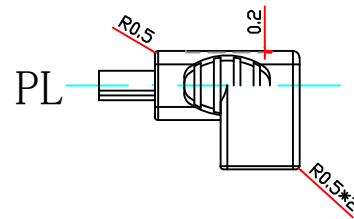
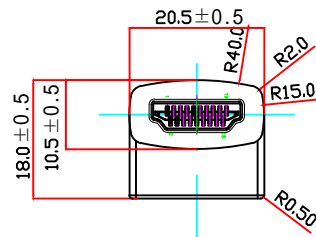
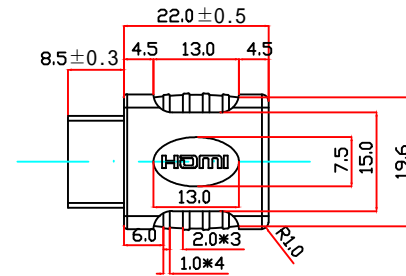

### PIN OUT

CN1	—	CN2	CN1	—	CN2
01	—	01	11	—	11
02	—	02	12	—	12
03	—	03	13	—	13
04	—	04	14	—	14
05	—	05	15	—	15
06	—	06	16	—	16
07	—	07	17	—	17
08	—	08	18	—	18
09	—	09	19	—	19
10	—	10	SHELL	—	SHELL

#### NOTES

- 1.Electric:  
Contact resistance:20M ohms max.  
Dielectric withstanding voltage:  
300V AC/1 min.  
Insulation resistance:  
100M ohms min.
- 2.Mechanical:  
Mating Force:45N max  
withdrawal force:10N min  
Durobilty:1500cycies min
- 3.Material:  
Operating Temperature:-55to+85°
- 4.HDMI-19P-  A  B  C

- A:(Shell finish)  
N:Nickel T:Tin  
G:Gold
- B:(Pin Finish)  
A: Sintver T: Tin N:Nickel
- B:Selcve plated gold 1U\*(G/F)  
C:Selcve plated gold 3U\*(G/F)  
D:Selcve plated gold 5U\*(G/F)  
E:Selcve plated gold 10U\*(G/F)  
F:Selcve plated gold 15U\*(G/F)  
G:Selcve plated gold 20U\*(G/F)  
H:Selcve plated gold 30U\*(G/F)  
I:Selcve plated gold 50U\*(G/F)
- M:Nickel front shell tin rear shell
- C:(Housing Coler)  
B:Black  
W:White
5. ⊗ Part NO

SCALE 1:1 UNIT mm	DWG NO	DESIGN	Aosion	CHECKED	APPROVED	
			REV	A1	DATE	PAGE:1/1