

MANTIS G

Quick Start Guide V1.0

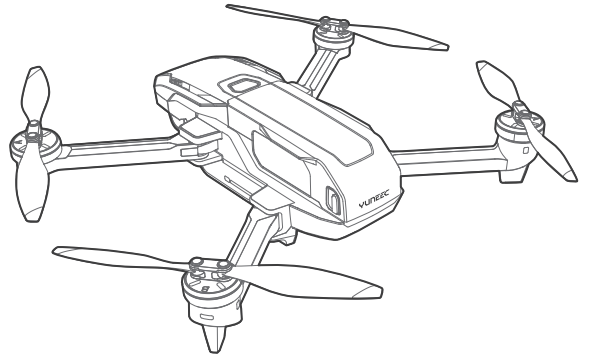

- EN:** Quick Start Guide
- DE:** Schnellstartanleitung
- ES:** Guía de inicio rápido
- FR:** Guide de démarrage rapide
- IT:** Guida rapida

Product Overview

Aircraft

Product Name: Mantis G

Model: YUNMGA

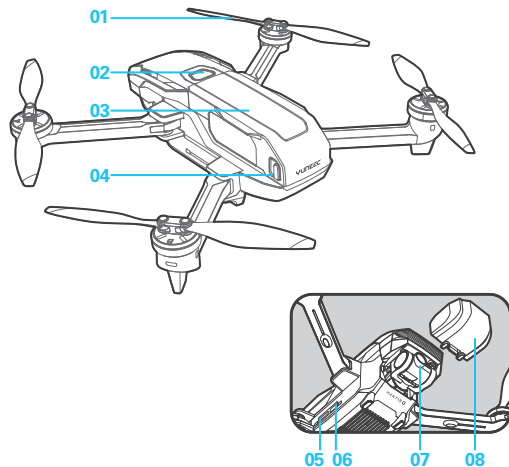

- 01 Propellers
- 02 Power Button
- 03 Battery
- 04 Battery Lock

- 05 USBType-C
- 06 Micro SD Card Slot
- 07 Camera
- 08 Gimbal Protector

Controller

Product Name: Mantis Q Remote Controller

Model: YUNMQRCP

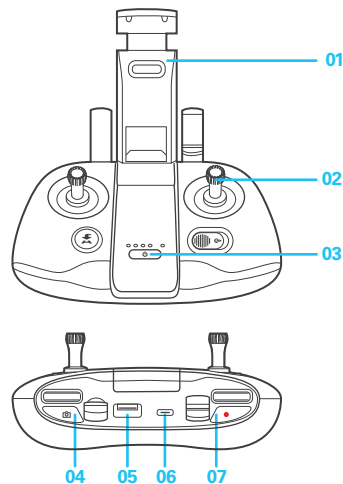

- 01 Phone Holder
- 02 Control Sticks
- 03 Power Button

- 04 Photo Button
- 05 Standard USB Port
- 06 USBType-C
- 07 Video Recording Button

Before Flight

1.Charging the Remote Controller

- Use USB Type-C (only for charging) to charge, approx. 2.5 hours.

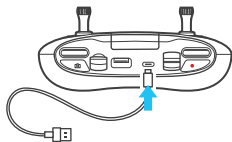

2.Preparing the Aircraft

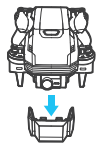

- ▶ Remove the gimbal protector

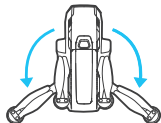

- ▶ Unfold the rear arms

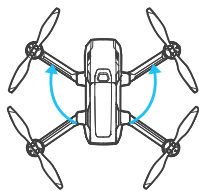

- ▶ Unfold the front arms

- Remove the gimbal protector.
- All arms and propellers must be unfolded before powering on.
- To fold the Mantis G, reverse the unfolding instructions.

3.Charging the Flight Battery

- Press the lock button and remove the flight battery.

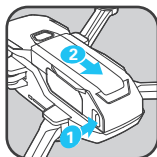

- Remove the insulation strip on the battery connector before use.

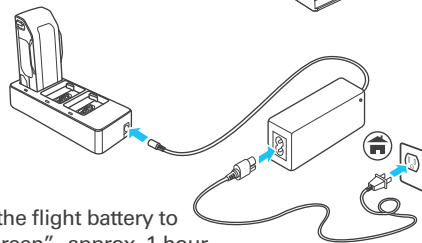
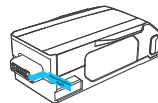

- Charge the flight battery to "Solid Green", approx. 1 hour.

- Push the flight battery into the aircraft until hearing a 'click'.

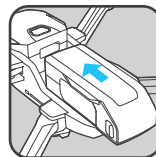

4.App Download

- Download Yuneec Pilot App. Mantis G supports iOS 10.0 (or later) or Android 5.0 (or later).



First Flight Part 1

1. Installing the Smart Device

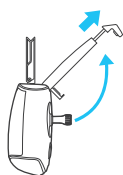

▶ Pull out the phone holder

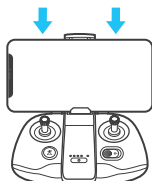

▶ Install the smart phone

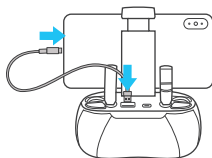

▶ Connect the smart phone with the remote controller (Iphone and Android cable not included)

2. Power On

To power on the Mantis G and the remote controller, press and hold the power button for two seconds until you hear two rising tones.

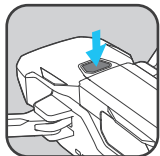

▶ Power on the Mantis G

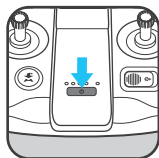

▶ Power on the controller

3. Connecting to Mantis G

- Launch Yuneec Pilot App.
- Tap the scan icon on the App screen and follow on-screen instructions to connect the aircraft with your control device (or manually select **Mantis Wi-Fi** in phone settings and enter the password to complete the connection. The password can be found on the aircraft QR Code sticker).

4. Take Off

- To ensure safe flight, step back approximately 9ft (3m) behind the Mantis G.

Option 1

Tap the icon [] on the app and then slide to take off.

Option 2

- Move the sticks for 1.5 seconds as shown below to start the motors.
- Slowly raise Left Stick to take off.

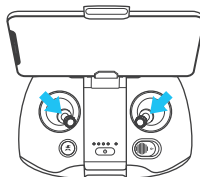

▶ Start the motors

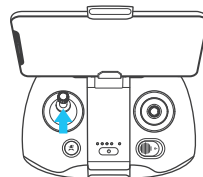

▶ Take off

First Flight Part 2

1.Direction Control

Move the control sticks as below to control the direction of the Mantis G.

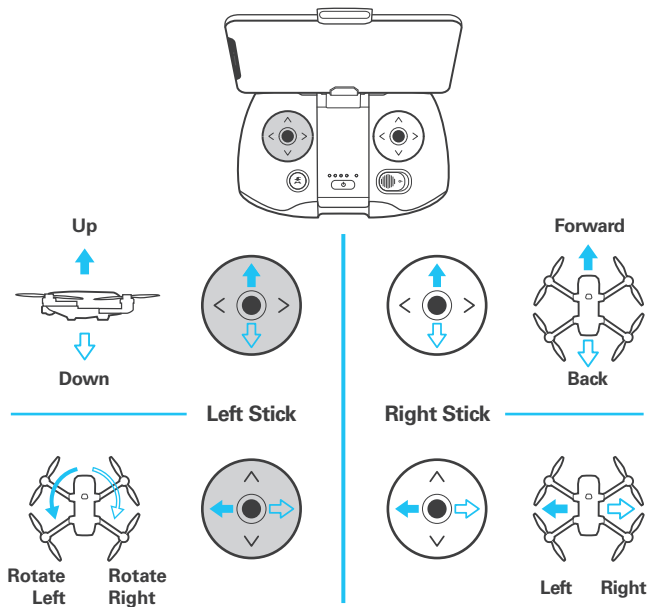

2.Landing

Option 1

Tap the icon [] on the app and then slide to land.

Option 2

Slowly lower Left Stick to land. To land properly, ensure that the aircraft is away from any obstacles or obstructions as it will land directly below where it is hovering.

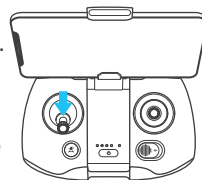

3.Power Off

- To power off the Mantis, press and hold the power button for two seconds.
- To power off the controller, press and hold the power button at the center of the controller for two seconds.

* If you experienced a slight drift during your first flight outdoor, it may be best to calibrate your compass and wait for GPS signal lock before take off. Please go to the Settings section within your app and follow the on-screen instructions to calibrate the compass.

Produktübersicht

DE

Fluggerät

Produktbezeichnung: Mantis G

Modell: YUNMGA

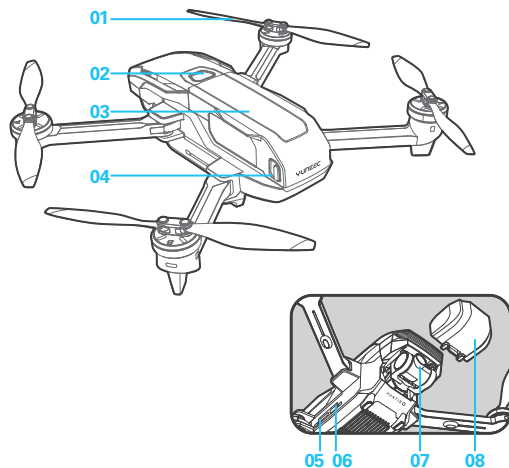

01 Propeller

02 Ein/Aus Schalter

03 Akku

04 Batteriefachverriegelung

05 USB Typ C

06 Steckplatz für Micro SD Card

07 Kamera

08 Gimbal Protector

Steuergerät

Produktbezeichnung: Mantis Q Fernsteuerung

Modell: YUNMQRC

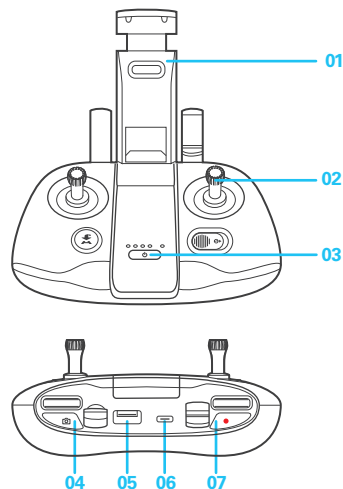

01 Telefonhalterung

02 Steuerknüppel

03 Ein/Aus Schalter

04 Foto-Taste

05 Standard USB-Anschluss

06 USB Typ C

07 Taste Videoaufnahme

Vor dem Flug

1. Fernbedienung laden

- Verwenden Sie zum Laden USB Typ C (nur zum Laden).
Dauer: etwa 2.5 Stunden.

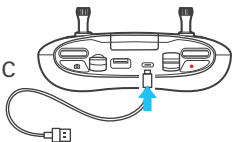

2. Fluggerät vorbereiten

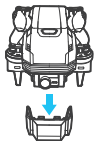

- ▶ Den Gimbal Protector entfernen.

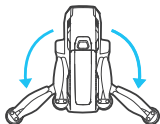

- ▶ Klappen Sie die hinteren Arme auf

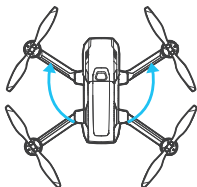

- ▶ Klappen Sie die vorderen Arme auf

- Vor dem Einschalten müssen alle Arme und Propeller aufgeklappt werden.
- Gehen Sie zum Zusammenklappen der Mantis G in umgekehrter Reihenfolge vor.

3. Flugakku laden

- Drücken Sie den Verriegelungsknopf und entnehmen Sie den Flugakku.

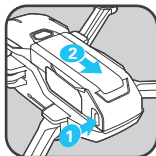

- Entfernen Sie vor dem Gebrauch den Isolationsstreifen am Batteriestecker.

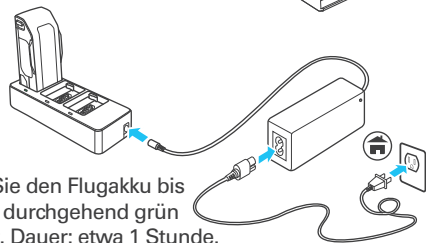
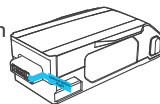

- Laden Sie den Flugakku bis die LED durchgehend grün leuchtet. Dauer: etwa 1 Stunde.

- Schieben Sie den Flugakku in das Fluggerät, bis Sie einen Klick hören.

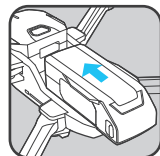

4. App Download

- Laden Sie die Yuneec Pilot App herunter. Mantis G unterstützt iOS 10.0 (oder neuer) oder Android 5.0 (oder neuer).



Erstflug Teil 1

1. Befestigung des Smartphones

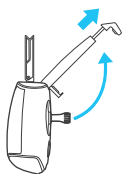

► Ziehen Sie die Telefonhalterung heraus

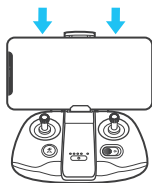

► Befestigen Sie Ihr Smartphone

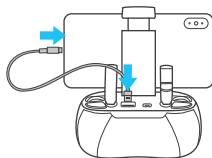

► Verbinden Sie das Smartphone mit der Fernbedienung (iPhone und Android-Kabel nicht im Lieferumfang enthalten)

2. Einschalten

Drücken und halten Sie zum Einschalten des Mantis G und der Fernsteuerung die Ein/Aus-Taste für etwa 2 Sekunden, bis Sie zwei aufsteigende Töne hören.

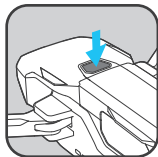

► Schalten Sie Mantis G ein

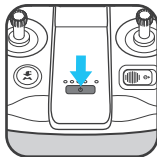

► Schalten Sie das Steuergerät ein

3. Mit Mantis Q verbinden

- Yuneec Pilot App starten.
- Tippen Sie in der App auf das Scan-Icon und folgen Sie den Anweisungen, um die Drohne mit Ihrer Steuerung zu verbinden (oder wählen Sie alternativ in den Einstellungen Ihres Telefons das **Mantis Wi-Fi** aus und geben Sie das Passwort ein, um die Verbindung zu etablieren. Das Passwort befindet sich auf dem QR-Code-Sticker der Drohne.)

4. Abheben

- Treten Sie für einen sicheren Flug etwa 3 m (9 ft.) vom Mantis Q zurück.

Option 1

Tippen Sie zum Abheben auf das Symbol [] in der App und schieben Sie es nach oben.

Option 2

- Bewegen Sie die Steuerknüppel für 1,5 Sekunden wie unten dargestellt, um die Motoren zu starten.
- Schieben Sie zum Abheben langsam den linken Steuerknüppel nach oben.

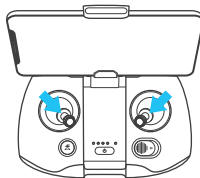

► Starten Sie die Motoren

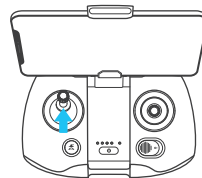

► Abheben

Erstflug Teil 2

1. Richtungssteuerung

Bewegen Sie die Steuerknüppel wie unten dargestellt, um die Flugrichtung des Mantis G zu steuern.

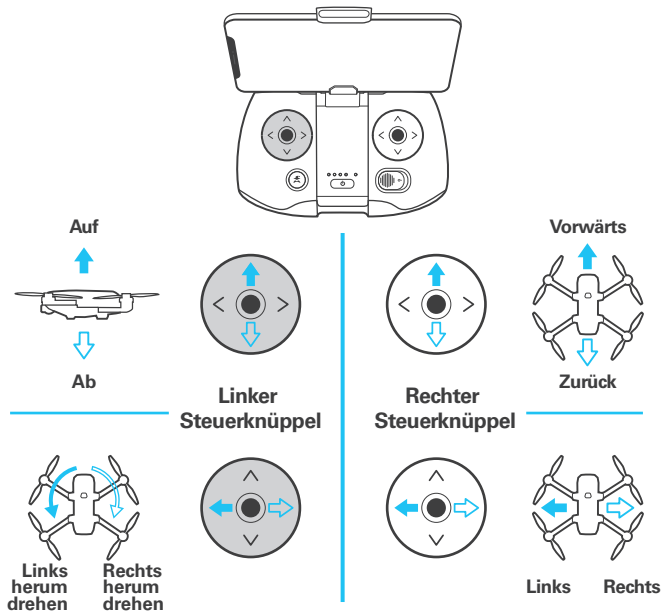

2. Landung

Option 1

Tippen Sie zum Landen auf das Symbol [] in der App und schieben Sie es nach unten.

Option 2

Schieben Sie zum Landen den linken Steuerknüppel langsam nach unten. Für eine ordnungsgemäße Landung stellen Sie sicher, dass sich die Drohne nicht in der Nähe von Hindernissen befindet, da Sie direkt an der Stelle landet, über der sie schwebt.

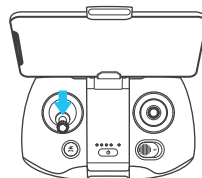

3. Abschalten

- Zum Ausschalten des Mantis, drücken und halten Sie den Power-Button für zwei Sekunden.
- Zum Ausschalten der Fernsteuerung, drücken und halten Sie den Power-Button in der Mitte des Controllers für zwei Sekunden

* Falls Sie bei Ihrem ersten Flug im Freien ein leichtes Abdriften feststellen, kann es hilfreich sein, vor dem nächsten Start den Kompass neu zu kalibrieren und zu warten, bis sich das GPS-Signal eingestellt hat. Um den Kompass zu kalibrieren, öffnen Sie die Einstellungen in der App und befolgen Sie die Anweisungen auf dem Bildschirm.

Vista general del producto

ES

Aeronave

Nombre del producto: Mantis G
Modelo: YUNMGA

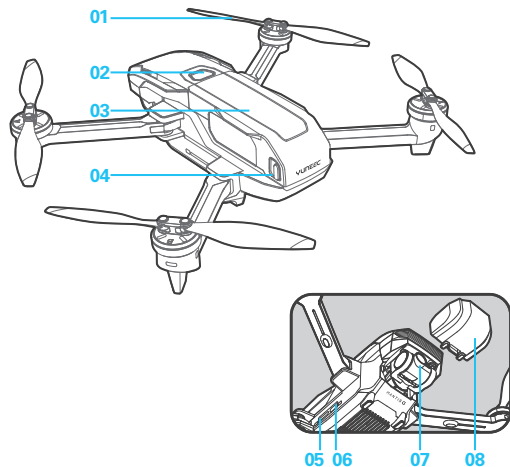

- 01 Hélices
- 02 Botón de encendido
- 03 Batería
- 04 Bloqueo de batería
- 05 USB tipo C
- 06 Ranura para tarjeta Micro SD
- 07 Cámara
- 08 Protector del cardán

Control remoto

Nombre del producto: Control remoto Mantis Q
Modelo: YUNMQRC

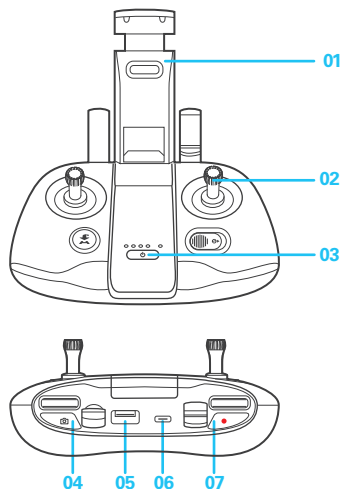

- 01 Soporte del teléfono
- 02 Mandos de control
- 03 Botón de encendido
- 04 Botón de foto
- 05 Puerto USB estándar
- 06 USB tipo C
- 07 Botón de grabación de vídeo

Antes del vuelo

1. Carga del control remoto

- Use un USB tipo C (solo para la carga) para cargarlo, aprox. 2.5 horas.

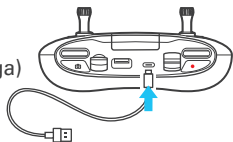

2. Preparación de la aeronave

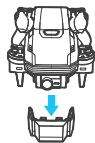

- ▶ Retire el protector del cardán

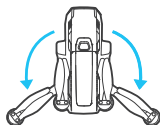

- ▶ Despliegue los brazos traseros

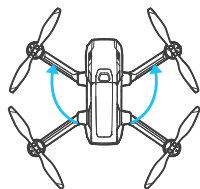

- ▶ Despliegue los brazos delanteros

- Todos los brazos y las hélices deben desplegarse antes de encenderse.
- Para plegar la Mantis G, invierta las instrucciones de despliegue.

3. Carga de la batería de vuelo

- Presione el botón de bloqueo y retire la batería de vuelo.

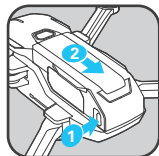

- Retire la tira de aislamiento en el conector de la batería antes de usar.

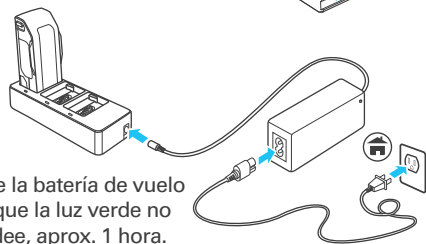
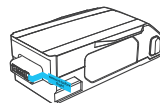

- Cargue la batería de vuelo hasta que la luz verde no parpadee, aprox. 1 hora.

- Empuje la batería de vuelo dentro de la aeronave hasta que escuche un 'click'.

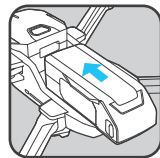

4. Descarga de la aplicación

- Descargar la aplicación Yuneec Pilot. Mantis G es compatible con iOS 10.0 (o posterior) o Android 5.0 (o posterior).



Primer vuelo - Parte 1

1.Instalación del dispositivo inteligente

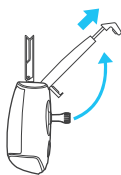

► Saque el soporte del teléfono

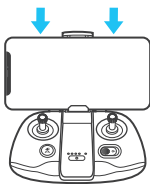

► Instale el teléfono inteligente

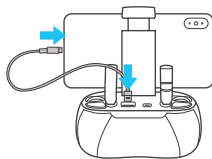

► Conecte el teléfono inteligente con el control remoto
(Cable para iPhone y Android no incluido)

2.Encendido

Para encender la Mantis G y el control remoto, mantenga pulsado el botón de encendido durante dos segundos hasta que oiga dos tonos ascendentes.

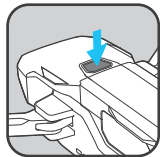

► Encienda la Mantis G

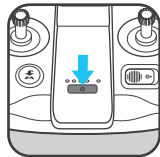

► Encienda el control remoto

3.Conectando con Mantis G

- Abrir aplicación Yuneec Pilot.
- Pulse el icono de escaneo en la pantalla de la aplicación y siga las instrucciones de la pantalla para conectar la aeronave a su dispositivo de control (o seleccione manualmente el **Wi-Fi Mantis** en la configuración del teléfono e introduzca la contraseña para completar la conexión. La contraseña se encuentra en la etiqueta del código QR de la aeronave).

4.Despegue

- Para garantizar un vuelo seguro, retroceda aproximadamente 9 pies (3 m) detrás de la Mantis G.

Opción 1

Pulse el icono [] en la aplicación y luego deslice para despegar

Opción 2

- Mueva los mandos durante 1,5 segundos como se muestra a continuación para arrancar los motores.
- Levante lentamente el mando izquierdo para despegar.

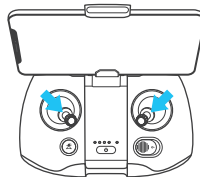

► Inicie los motores

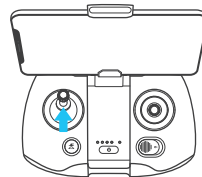

► Despegue

Primer vuelo - Parte 2

1. Control de dirección

Mueva los mandos de control como se indica a continuación para controlar la dirección de la Mantis G.

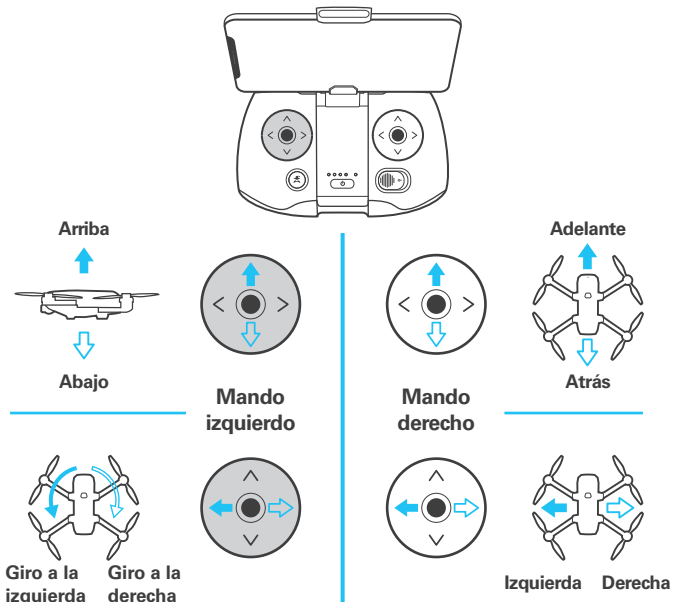

2. Aterrizaje

Opción 1

Pulse el icono [↓] en la aplicación y luego deslice para aterrizar.

Opción 2

Baje lentamente el control izquierdo para aterrizar. Para aterrizar correctamente, asegúrate de que la aeronave está lejos de cualquier obstáculo, ya que aterrizará justo debajo de donde esté planeando.

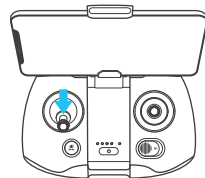

3. Apagado

- Para apagar el Mantis G, mantén pulsado el botón de encendido durante dos segundos.
- Para apagar el controlador, mantén pulsado el botón de encendido del centro del controlador durante dos segundos.

* Si ha notado una ligera desviación durante el primer vuelo en exterior, es recomendable calibrar la brújula y esperar a que se establezca una conexión GPS antes de despegar. Por favor, acceda a la sección de Ajustes de su aplicación y siga las instrucciones en pantalla para calibrar la brújula.

Aperçu du produit

FR

Drone

Nom du produit: Mantis G
Modèle: YUNMGA

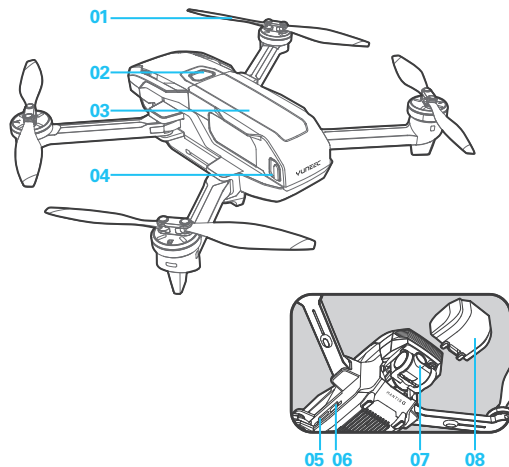

- 01 Hélices
- 02 Bouton d'alimentation
- 03 Batterie
- 04 Verrouillage batterie
- 05 USB Type-C
- 06 Fente pour micro carte SD
- 07 Caméra
- 08 Protège-cardan

Manette de contrôle

Nom du produit: Mantis Q - Télécommande
Modèle: YUNMQRC

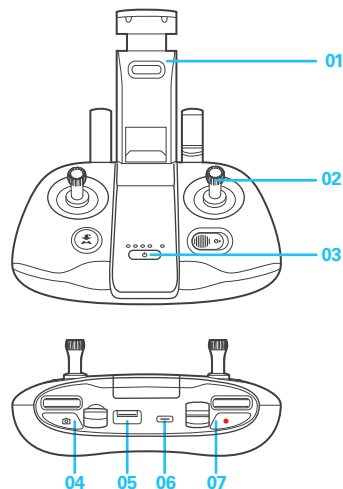

- 01 Support téléphone
- 02 Manettes de commande
- 03 Bouton d'alimentation
- 04 Bouton photo
- 05 Port USB standard
- 06 USB Type-C
- 07 Bouton enregistrement vidéo

Avant le vol

1.Recharge de la télécommande

- Utiliser USB Type-C (uniquement pour le chargement) pour la recharge, approx. 2.5 heures.

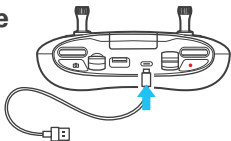

2.Préparation du drone

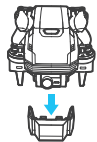

- ▶ Retirez le protège-cardan.

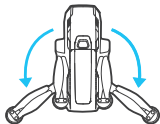

- ▶ Déplier les bras arrière

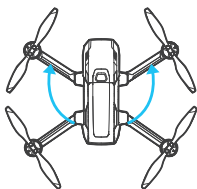

- ▶ Déplier les bras avant

- Tous les bras et les hélices doivent être dépliés avant la mise sous tension.
- Pour replier le Mantis G, suivez les instructions dans l'ordre inverse.

3.Recharge de la batterie de vol

- Appuyer sur le bouton de verrouillage et retirer la batterie de vol.

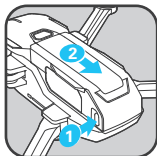

- Retirez la bande isolante du connecteur de la batterie avant utilisation.

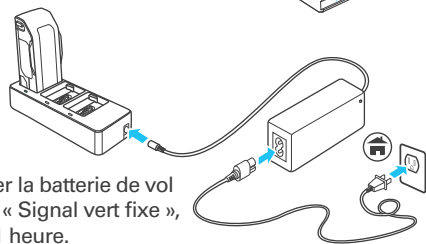
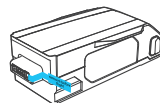

- Recharger la batterie de vol jusqu'au « Signal vert fixe », approx. 1 heure.

- Pousser la batterie de vol dans le drone jusqu'à ce que vous entendiez un « clic ».

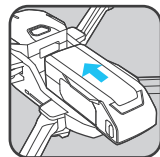

4.Téléchargement de l'application

- Télécharger l'appli Yuneec Pilot. Mantis G est compatible avec iOS 10.0 (ou version ultérieure) ou Android 5.0 (ou version ultérieure).



Premier vol Partie 1

1. Installation de l'appareil intelligent

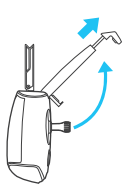

► Sortir le support du téléphone

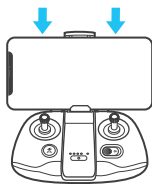

► Installer le smartphone

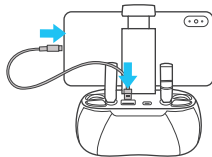

► Connecter le smartphone avec la télécommande
(Le câble pour iPhone et Android n'est pas inclus)

2. Allumer

Pour allumer le Mantis G et la télécommande, appuyez sur le bouton d'alimentation et maintenez-le appuyé pendant deux secondes jusqu'à ce que vous entendiez deux tonalités croissantes.

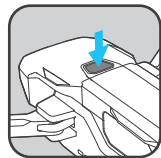

► Allumez le Mantis G

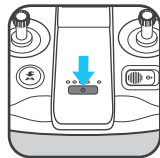

► Allumez la télécommande

3. Connexion à Mantis G

- Démarrez l'appli Yuneec Pilot.
- Appuyez sur l'icône de recherche sur l'écran de l'application et suivez les instructions inscrites à l'écran pour connecter l'avion à votre appareil de contrôle (ou sélectionnez manuellement le **WiFi Mantis** dans les paramètres du téléphone et entrez le mot de passe pour terminer la connexion. Le mot de passe se trouve sur l'étiquette du code QR de l'avion).

4. Décollage

- Afin d'assurer un vol en toute sécurité, reculez-vous d'environ 9 pieds (3 m) par rapport au Mantis G.

Option 1

Appuyez sur l'icône [] sur l'appli, puis faites glisser pour décoller.

Option 2

- Actionnez les manettes pendant 1,5 seconde comme indiqué ci-dessous pour démarrer les moteurs.
- Relevez doucement la manette gauche pour décoller.

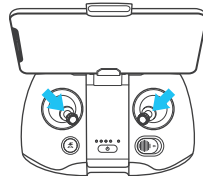

► Démarrez les moteurs

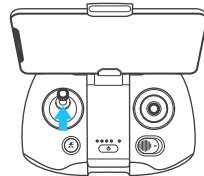

► Décollage

Premier vol Partie 2

1. Contrôle de la direction

Actionnez les manettes de commande comme indiqué pour contrôler la direction du Mantis G.

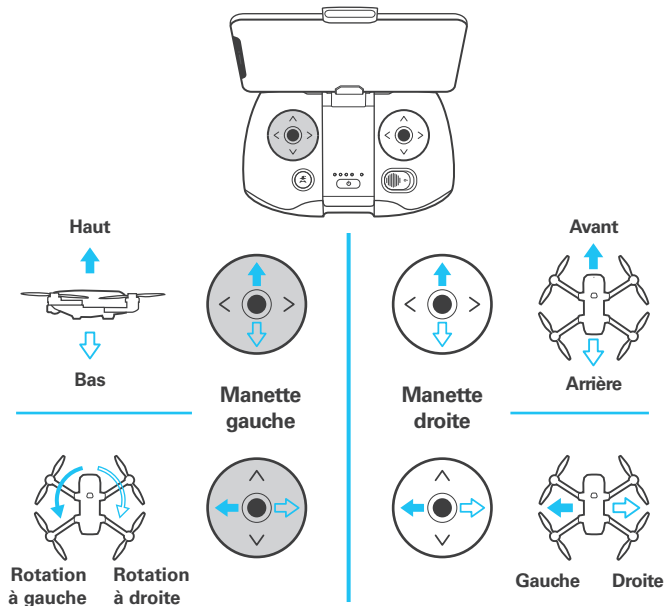

2. Atterrissage

Option 1

Appuyez sur l'icône [] sur l'appli, puis faites glisser pour atterrir.

Option 2

Abaissez doucement la manette gauche pour atterrir. Pour atterrir correctement, assurez-vous que le drone est loin de tout obstacle ou de toute obstruction, car il atterrira directement en dessous de l'endroit où il se trouve en vol stationnaire.

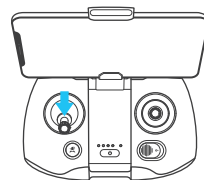

3. Éteindre

- Pour éteindre le Mantis G, appuyez sur le bouton d'alimentation et maintenez-le appuyé pendant deux secondes.
- Pour éteindre la manette, appuyez sur le bouton d'alimentation situé au centre de la manette et maintenez-le enfoncé pendant deux secondes.

* Si vous avez observé une légère dérive lors de votre premier vol en plein air, nous vous recommandons de calibrer votre boussole et d'attendre le verrouillage du signal GPS avant le décollage. Veuillez vous rendre dans la section Paramètres de votre application et suivre les instructions à l'écran pour calibrer la boussole.

Panoramica prodotto

IT

Velivolo

Nome prodotto: Mantis G

Modello: YUNMGA

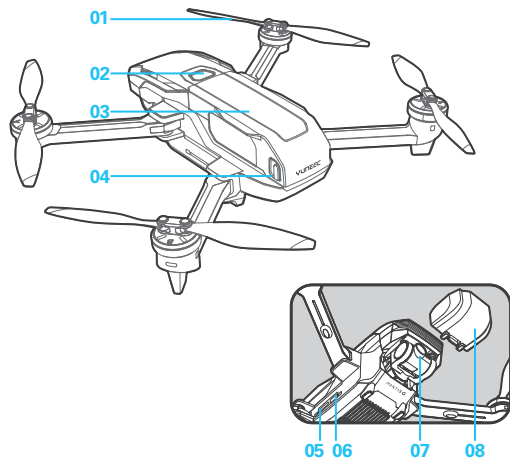

01 Eliche

02 Pulsante di accensione

03 Batteria

04 Blocco batteria

05 USB tipo C

06 Alloggiamento micro

scheda SD

07 Videocamera

08 Protezione della
sospensione cardanica

Radiocomando

Nome prodotto: Radiocomando Mantis Q

Modello: YUNMQRC

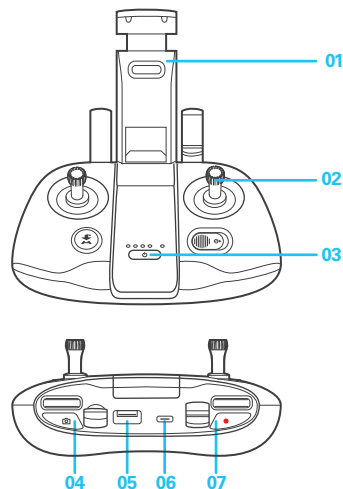

01 Supporto telefono

02 Manopole di comando

03 Pulsante di accensione

04 Pulsante foto

05 Porta USB standard

06 USB tipo C

07 Pulsante di videoregistrazione

Prima del volo

1. Carica del radiocomando

- Per caricare utilizzare la USB tipo C (solo per caricare) per circa 2.5 ore.

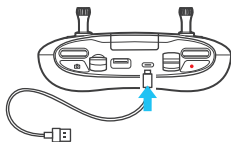

- Retirez la bande isolante del connecteur de la batterie avant utilisation.

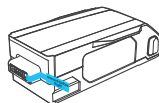

2. Preparazione del velivolo

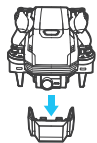

- ▶ Rimuovere la protezione della sospensione cardanica.

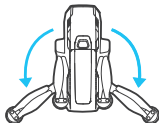

- ▶ Aprire i bracci posteriori

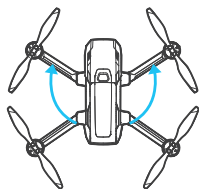

- ▶ Aprire i bracci anteriori

- Prima dell'accensione tutti i bracci e le eliche devono essere aperti.
- Per ripiegare il Mantis G seguire le istruzioni di apertura nell'ordine contrario.

3. Carica della batteria di volo

- Premere il pulsante di blocco e rimuovere la batteria di volo.

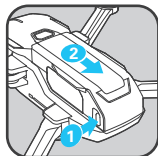

- Inserire la batteria di volo nel velivolo spingendola fino a sentire un "clic".

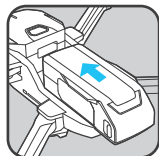

4. Scaricare l'app

- Scaricare l'App Yuneec Pilot. Mantis G supporta iOS 10.0 (o successivi) o Android 5.0 (o successivi).



Primo volo Parte 1

1. Installazione dello smartphone

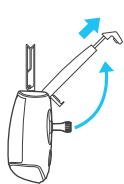

► Estrarre il supporto per il telefono

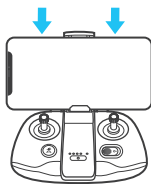

► Inserire lo smartphone

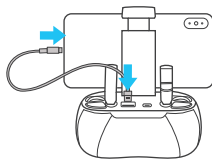

► Collegare lo smartphone al radiocomando
(Cavo iPhone e Android non incluso)

2. Accensione

Per accendere il Mantis G e il radiocomando, premere il pulsante di accensione e tenerlo premuto per due secondi fino a sentire due suoni crescenti.

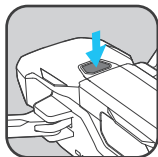

► Accendere il Mantis G

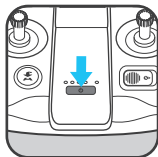

► Accendere il radiocomando

3. Connessione a Mantis G

- Lanciare l'app Yuneec Pilot.
- Toccare l'icona di ricerca nella schermata dell'app e seguire le istruzioni visualizzate per collegare il velivolo al proprio dispositivo di comando (oppure selezionare manualmente **Mantis Wi-Fi** nelle impostazioni del telefono e immettere la password per completare il collegamento. La password è riportata sull'adesivo con il codice QR del velivolo).

3. Decollo

- Per garantire un volo sicuro arretrare di circa 3 metri (9 ft) rispetto al Mantis G.

Opzione 1

Toccare l'icona [] dell'App e poi scorrere per decollare.

Opzione 2

- Per avviare muovere le manopole per 1,5 secondi come illustrato di seguito.
- Per decollare sollevare lentamente la manopola sinistra.

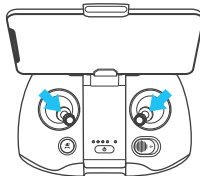

► Avviare i motori

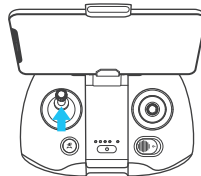

► Decollo

Primo volo Parte 2

1. Controllo della direzione

Per controllare la direzione del Mantis G muovere le manopole di comando come illustrato di seguito.

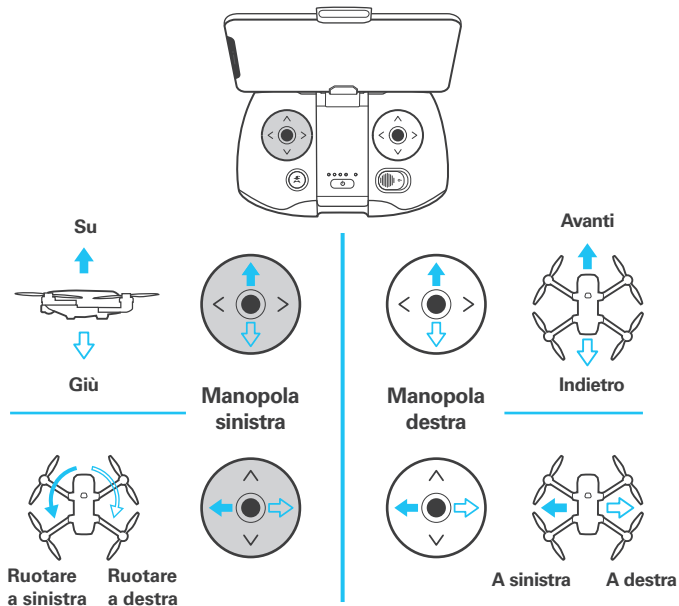

2. Atterraggio

Opzione 1

Toccare l'icona [] dell'App e poi scorrere per atterrare.

Opzione 2

Per atterrare abbassare lentamente la manopola sinistra. Per atterrare correttamente, assicurarsi che il velivolo sia lontano da ostacoli od ostruzioni, poiché atterrerà direttamente sotto il punto in cui staziona in hovering.

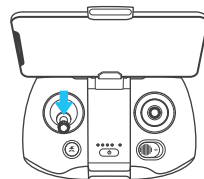

3. Spegnimento

- Per spegnere il Mantis, premere il pulsante di accensione e tenerlo premuto per due secondi.
- Per spegnere il controller, premere il pulsante di accensione al centro del controller e tenerlo premuto per due secondi.

* Se si è riscontrata una leggera deviazione durante il primo volo all'aperto, si consiglia di regolare la bussola e di attendere il segnale GPS prima del decollo. Selezionare la sezione Impostazioni nella propria app e seguire le istruzioni sullo schermo per regolare la bussola.

YUNEEC

Any information might be changed due to the software update. For the latest documents, please check the official website: www.yuneeec.com