

# AUTOMOTIVE RÜCKFAHRKAMERA RVC 2.0

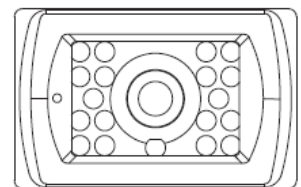
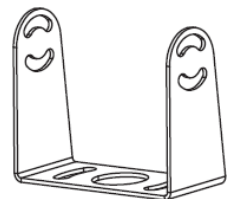
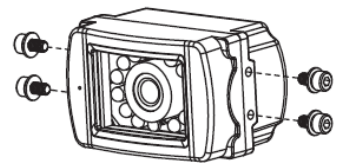

Subject to availability and technical modification.

**Verkaufsstart**

JUNI 2019

**Order Number**

2 009 019 000 000

**EAN-Code**

4 260 499 851 927

**Highlights**

- 12-V Automotive Rückfahrkamera
- PAL
- High Performance CCD Sensor
- IR LED Low Light Optimierung
- Wasserfest (IP69K)
- Breiter Blickwinkel 95 (H), 80 (V), 120 (D)
- Auflösung: 480 TV Linien
- Min. Beleuchtung:  
1.0 Lux at F2.0  
0 Lux mit IR an
- Abmessungen: 77 (W), 44.6 (H), 55 (D) mm
- Arbeitstemperatur: -30 C ~ +70 C
- Gewicht: ca. 0.50 Kg
- Weißes Gehäuse

## AUTOMOTIVE RÜCKFAHRKAMERA RVC 2.0

2/2

### Inhalt:

Kamera  
Halterung  
Hardware-Kit

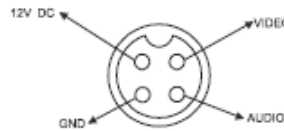

### Installation und Pin Out:

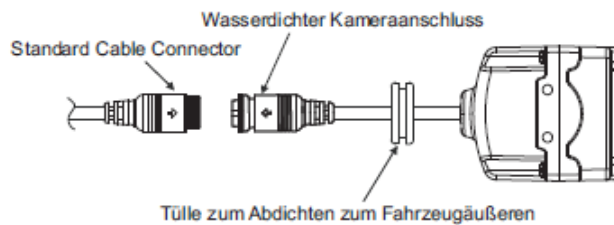

### Endansicht Kabelanschluss

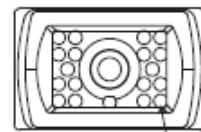

LED-unterstützte  
Beleuchtung

### Halterung Lochabmessungen

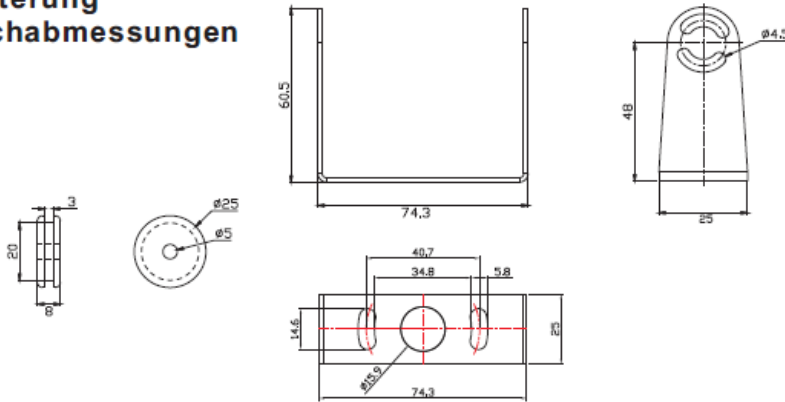

Unit: MM

2

### Empfohlenes Tüllenloch

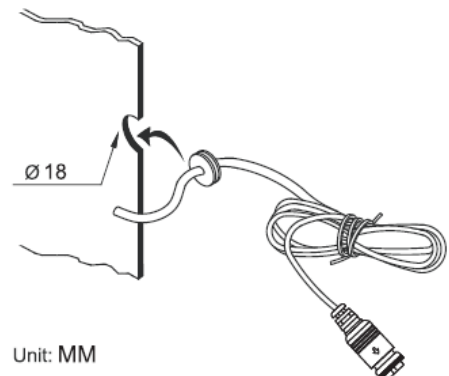
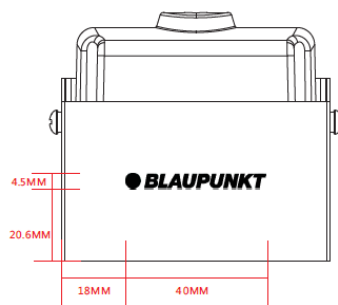

Unit: MM