



INSTALLATIONSHANDBUCH

CLUB 605CSQ

CLUB 625SQ

CLUB 605CSQ

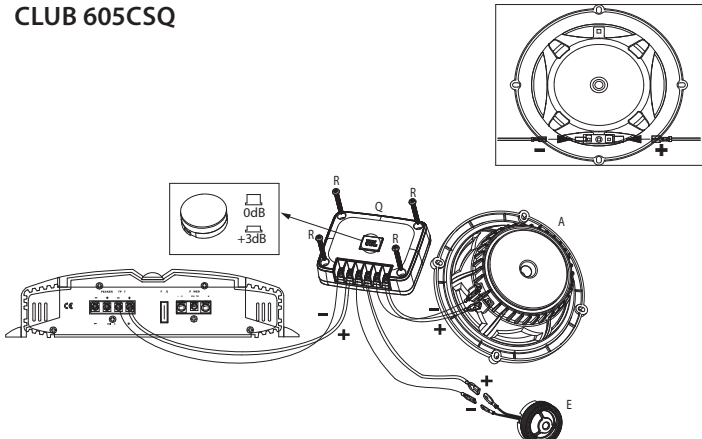

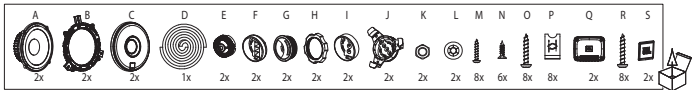
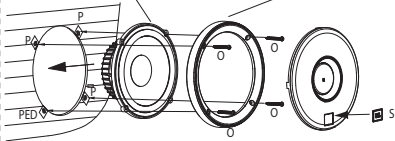
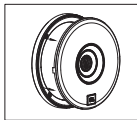
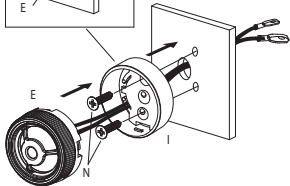
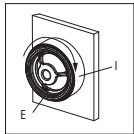

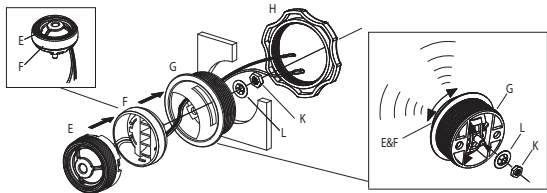
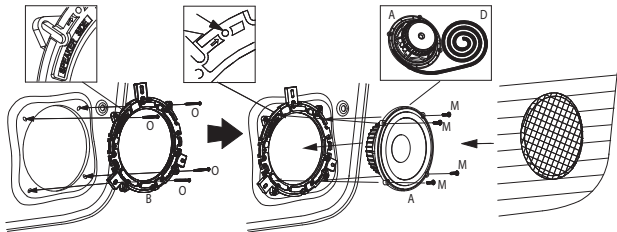

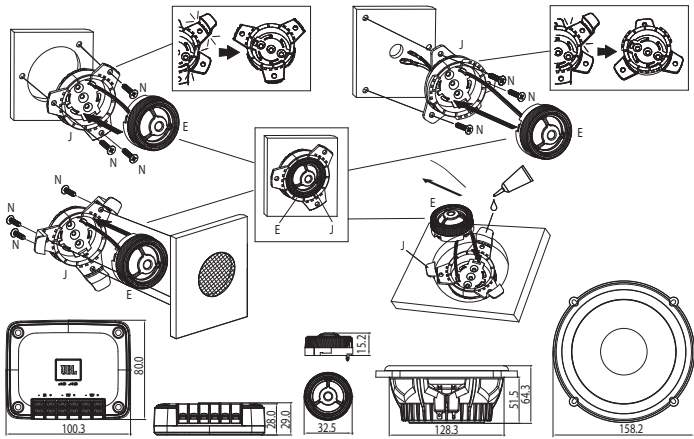

Technische Daten

- Typ: 6-1/2" (160 mm) 2-Wege-Komponenten-Lautsprechersystem, für die ultimative Soundleistung konstruiert.
- Netzversorgung: 95 W RMS, 285 W Spitze
- Empfindlichkeit (bei 2,83 V): 93 dB
- Frequenzbereich: 48 Hz – 21 kHz
- Nennimpedanz: 3,0 Ohm

Thiele-Small-Parameter

- BL (Tm): 3.776
- DCR (ohms): 2.09
- Mms (g): 13.238
- Sd (cm²): 132.73
- Cms (µm/N): 0.536
- Vas (l): 13.3648
- Fs (Hz): 59.7
- Qes: 0.728
- Qms: 8.315
- Qts: 0.670
- Crossover Point: 5 kHz

CLUB 625SQ

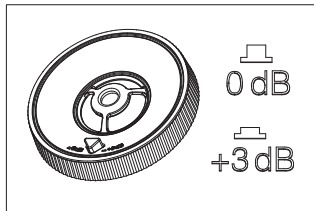
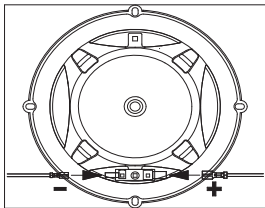

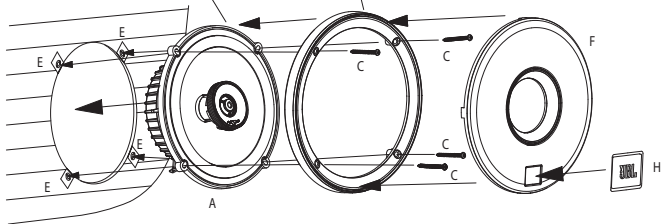
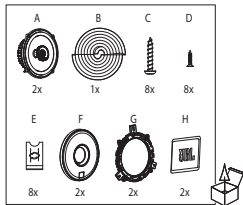
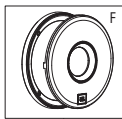

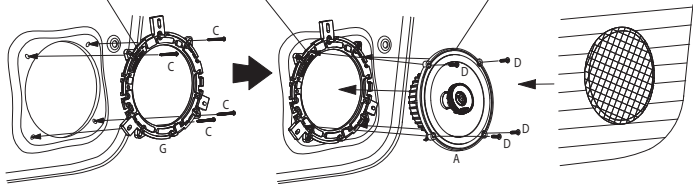
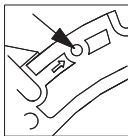
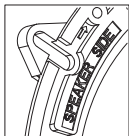

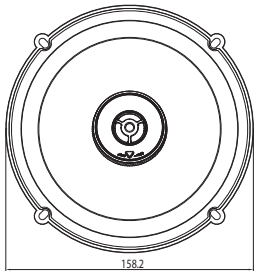
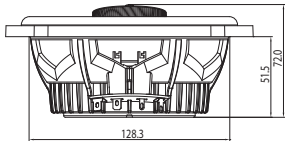

Technische Daten

- Typ: 6-1/2" (160 mm) 2-Wege-Auto-Lautsprecher, für die ultimative Soundleistung konstruiert.
- Netzversorgung: 75 W RMS, 225 W Spitze
- Empfindlichkeit (bei 2,83 V): 93 dB
- Frequenzbereich: 48 Hz – 21 kHz
- Nennimpedanz: 3,0 Ohm

Thiele-Small-Parameter

- BL (Tm): 3.748
- DCR (ohms): 2.12
- Mms (g): 12.273
- Sd (cm²): 132.73
- Cms (µm/N): 0.530
- Vas (l): 13.2162
- Fs (Hz): 62.4
- Qes: 0.724
- Qms: 9.037
- Qts: 0.671
- Crossover Point: 5 kHz



HARMAN International
Industries, Incorporated
8500 Balboa Boulevard,
Northridge, CA 91329 USA

© 2020 HARMAN International
Industries, Incorporated.

Alle Rechte vorbehalten. JBL ist eine Marke von HARMAN International Industries, Incorporated, registriert in den Vereinigten Staaten und/oder anderen Ländern.

Merkmale, Spezifikationen und Design können ohne vorherige Ankündigung geändert werden.