

LED Table Luminaire E27 – CAMILLO

Instruction Manual



TECHNICAL SPECIFICATION:

Series Name	CAMILLO			
Model Number	LM85700	LM85701	LM85702	LM85703
Color	Black	White	Petrol	Ruby-Red
Lamp Holder	E27			
Lamp Wattage (LM85135)	4,5W			
Voltage	220-240V~			
Frequency	50/60 Hz			
IP Rating	IP20			

CAUTIONS:

- Read the entire manual carefully before installation and operation.
- DO NOT disassemble the inner part of the luminaire. Doing so may result in luminaire damage or malfunction.
- Switch OFF the power source before installation, replacement and cleaning! ⚠
- Wearing gloves during installation is recommended to ensure the luminaire is kept in the best condition.
- Before replacement of the lamp or luminaire, turn it off and allow it to cool down. Heat-resistant gloves are mandatory when handling the luminaire.
- The manufacturer accepts no liability for any damage resulting from the misuse of the luminaire or from when it is used with inappropriate equipment.
- Consult your dealer if you have any enquiries.

ATTENTION:

- Instant start is allowed.
- Designed for indoor applications.
- The operating temperature of the luminaire is -20°C to +40°C.

INSTALLATION

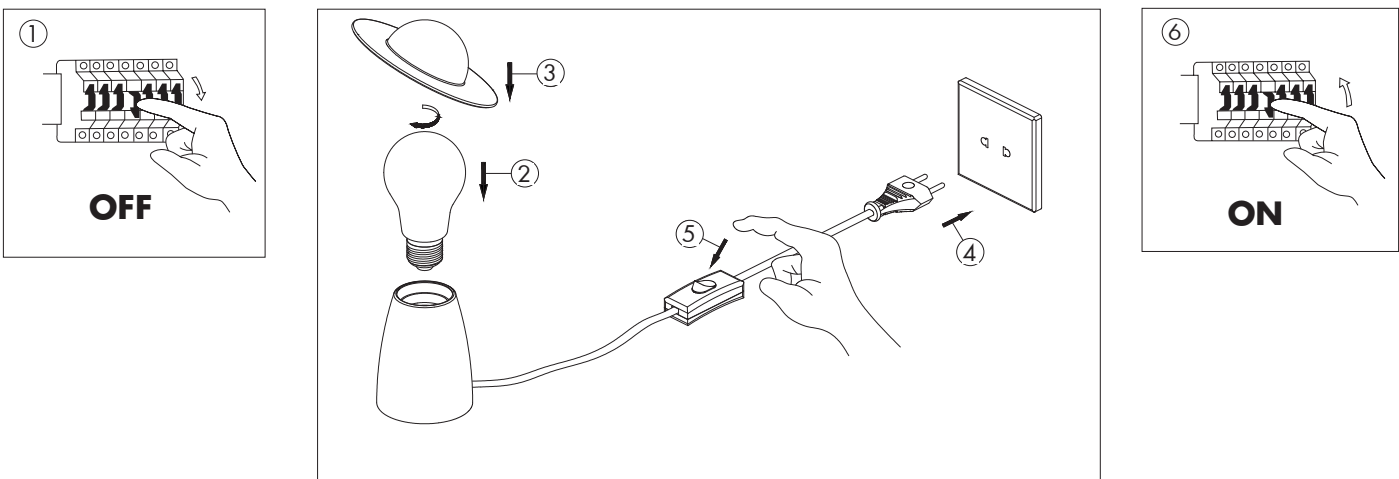

1. Turn OFF the power.
2. Insert the lamp (LM85135) into the lamp holder.
3. Attach the adjustable luminaire cap on the lamp head.
4. Connect the luminaire to the mains.
5. Turn on the luminaire.
6. Turn ON the power.

Correct disposal of this product:



This marking indicates that this product should not be disposed with other household wastes throughout the EU. To prevent possible harm to the environment or human health from uncontrolled waste disposal, recycle it responsibly, to promote the sustainable reuse of material resources. To return your device, please use the return and collection systems, or contact the retailer where the product was purchased. They can take this product for environmental safe recycling.