

size:145X210mm

# MAGNA HOLD ADJUSTABLE SAWHORSE

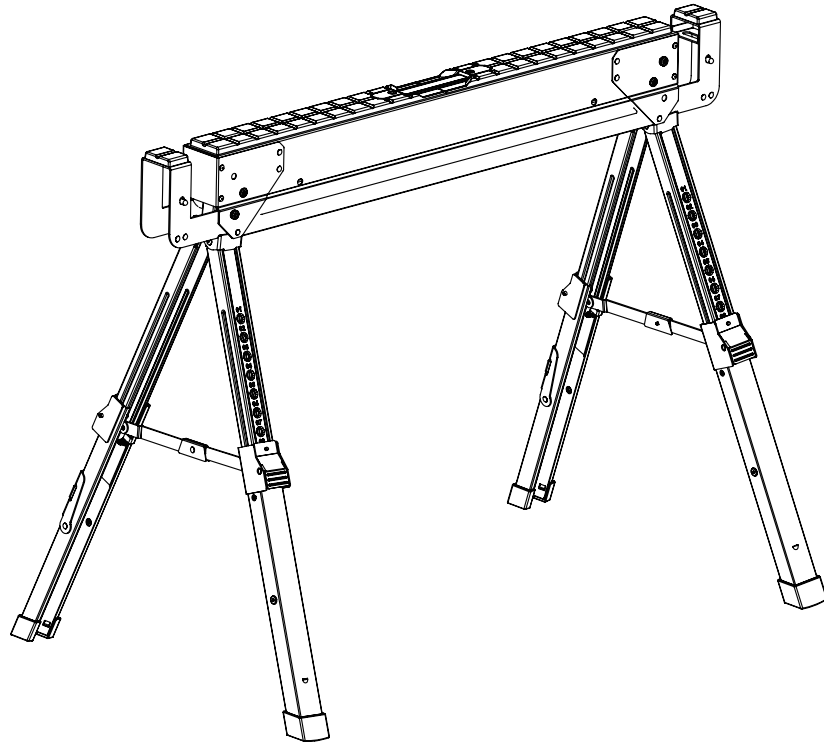

## ▲ SAFETY INFORMATION

Please read and understand this entire manual before attempting to operate the product.

### ▲ WARNING/ADVERTENCIA

- When lifting the sawhorse, use proper lifting techniques to avoid personal injury.
- Ensure work area is well lit while working.
- Ensure sawhorse is standing on a level surface that is clear, dry and free of debris.
- Ensure all 4 legs have solid contact with the floor. If the sawhorse is not positioned level and straight, loads placed upon it could fall, potentially causing damage to the item(s) loaded on it, and possible severe personal injury or death.
- Ensure the load placed on any sawhorse does not exceed the applicable Safe Working Load Rating. Overloading can lead to failure of the sawhorse, potentially causing damage to the item(s) loaded on it, and possible severe personal injury or death.
- Never stack sawhorses to obtain extra height.

## ▲ SAFETY INFORMATION

### CAUTION

- Do not apply weight in excess of 589kg of uniformly distributed load on sawhorse.
- Do not use as a step ladder or standing platform.
- Uniformly Distributed Load: The maximum uniformly distributed load across the top rail of the sawhorse PER EACH SAWHORSE. All weight should be distributed evenly on the top rail. The amount of weight that can be applied (uniformly distributed) to two identical sawhorses is double the value as stated on the retail sticker and instruction manual.

## SET-UP INSTRUCTIONS

1. Sawhorse in folded/carry position.

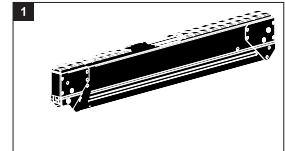

2. Above location labeled "Open 1", press release button and pull down legs until the 45x95mm supports are fully deployed.

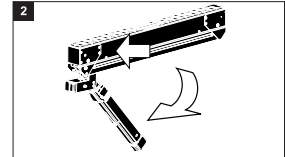

3. Separate legs and push cross brace flat.

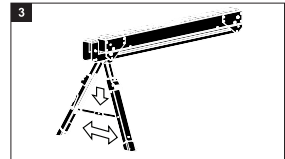

## SET-UP INSTRUCTIONS

4. Above location labeled "Open 2", press release button and fold down legs until the 42x90mm supports are fully deployed.

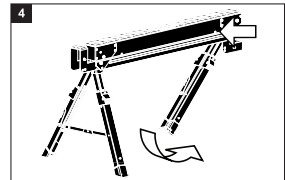

5. Separate legs and push cross brace flat.

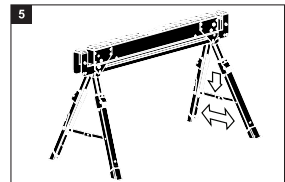

6. Legs adjust in increments of 2.54cm. To extend, pull legs down until latch is locked at desired position. To retract, press lock button, pull legs down slightly then push leg up.

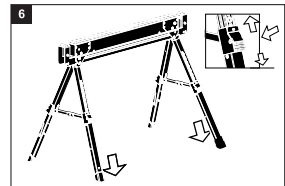

7. When paired together with a second unit and properly joined by the 45x95mm support arms, a work table can support up to 1178kg.

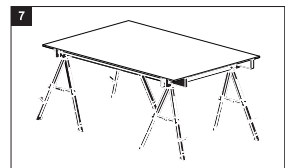

## HOW TO CLOSE

1. To close, reverse steps 5 through 2, starting with leg 2.
2. Be sure locking pin engages main housing to keep legs secure while in folded/carry position.