

OPERATING MANUAL

Infrared Radiant Heater

SHX49HEAT2022

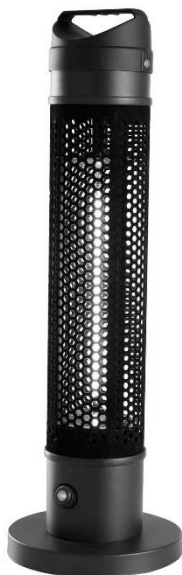

CONGRATULATIONS!

THANK YOU FOR PURCHASING THIS SHX PRODUCT.



EN

FR

IT

NL

SE

CZ

SK

RO

EN



TABLE OF CONTENTS

EN

Important information on safety, place of use and electrical connections
Recycling, disposal and Declaration of Conformity
Scope of delivery
Description of the appliance
Place of use and connection to power supply
Starting up and functions
Cleaning and maintenance
Technical information
Warranty

PLEASE READ THE OPERATING MANUAL CAREFULLY BEFORE BEGINNING ASSEMBLY,, INSTALLATION, OPERATION OR MAINTENANCE. PROTECT YOURSELF AND OTHERS BY FOLLOWING THE SAFETY INSTRUCTIONS. FAILURE TO COMPLY WITH THESE INSTRUCTIONS MAY RESULT IN PERSONAL INJURY AND/OR PROPERTY DAMAGE AND/OR LOSS OF CLAIMS UNDER WARRANTY.



Intended Use

This appliance is splash-water protected (IP44). This appliance is intended for heating in covered outdoor areas (e.g. terraces). The appliance is suited for occasional use and not for continuous operation. The appliance is intended for private use and not for commercial use. The appliance may only be operated when connected to 220–240 V AC/50 Hz (10/16A) earthed contact sockets.

Any other use than described above will cause damage to the appliance. In addition, there is a risk of short circuit, fire or electric shock. The appliance may neither be modified, opened nor altered.

IMPORTANT INFORMATION ON SAFETY, STANDARDS AND ELECTRICAL CONNECTIONS



Safety notes

WARNING: This appliance is not equipped with a thermostat for controlling the room temperature.

WARNING: Do not use the heater in small rooms when they are occupied by persons who are not capable of leaving the room on their own, unless constant supervision is provided.



WARNING: This appliance is intended exclusively for the heating of sheltered outdoor areas and may not be used for any other purpose.

WARNING: Do not spray the appliance!

1. The appliance is not suitable for continuous or high-precision operation
2. Remove the appliance from the packaging and check that it is in good working order.
3. Keep the packaging materials away from children. **If swallowed, these pose a risk of suffocation!**
4. Check whether the power supply in your household corresponds with the information provided on the radiant heater.
5. Check the power cable and plug before use to make sure they are not damaged.
6. Always make sure that the appliance is switched off before unplugging the power cable. Only switch on the appliance with dry hands. Otherwise: There is a risk of electric shock!
7. Do not put any flammable objects close to the radiant heater, and do not direct the radiant heater towards such objects. Make sure that the front of radiant heater is set up or installed at least 1 metre away from bedding, paper, clothing and curtains. It is best to set the radiant heater up beside or with its back facing such items.



WARNING: Do not set up close to water (bathtubs, pools, etc.).

8. To protect against electric shock, do not immerse the power cable or plug in water or any other liquids.

9. Do not insert any foreign objects in the air outlets. Attention: Risk of electric shock, fire or damage!

10. Unplug from the power socket when not in use. Do not let the cables hang over the table in order to protect your children.

11. Do not insert your fingers or foreign objects through the grille while the appliance is in operation.

12. Do not leave the appliance unsupervised.

13. Do not use the radiant heater in the bathroom, laundry room or any similar locations. Do not set the appliance up near a bathtub or any other vessels containing water.

14. No liability is accepted for damage which arises from non-adherence to this operating manual or improper use.

15. The heater must not be installed directly below a wall power socket.

16. This appliance cannot be used by persons (including children) with reduced physical or mental capabilities, unless they are supervised or an adult has given them instruction concerning use of the appliance in a safe way.

17. Children and other persons needing assistance shall not play with the appliance.



18. Keep children under the age of 3 away from the appliance unless they are under constant supervision.

19. Children between the ages of 3 and 8 may only switch the appliance on or off under supervision or if they have been instructed in its safe use and understand the resultant dangers, on the condition that the appliance is positioned or installed in its normal place of use.

20. Connection as well as control, cleaning and user maintenance may not be carried out by children between the ages of 3 and 8. Children shall not play with the appliance.

CAUTION: The appliance is not designed to be operated with an external timer or a separate remote control system.

21. The appliance must always be disconnected from the power supply when left unattended and before cleaning it.

22. Always let the appliance cool down completely before cleaning it or putting it in storage. Parts of the radiant heater such as the heating tube, reflector and surrounding metal parts may reach temperatures above 200°C. Risk of injury due to severe burns! Do not touch hot surfaces!

23. Do not make any modifications to the appliance. Do not replace the connection cable yourself.

24. To prevent overloading a circuit, do not operate the radiant heater on a circuit with other equipment.

25. Avoid using extension cables as they are more prone to overheating and therefore constitute a fire hazard.



26. The connection cable cannot be replaced. The appliance must be disposed if the cable is damaged.

27. Do not run the connection cable under carpeting, and do not cover the cable. Make sure that nobody can trip over the cable.

Do not wrap the connection cable around the appliance.

28. Do not use the appliance in direct sunlight or near other sources of heat. The appliance should not be exposed to outdoor weather for an extended period.

29. The minimum distance between the radiant heater and the floor should be 180 cm and a distance of 40 cm should be kept on the sides in order to ensure sufficient distance is kept between the appliance and people/animals and to prevent burns. The heating element should not be directed toward the ceiling, instead it should always be directed toward the area to be heated.

30. Never cover the radiant heater under any circumstances in order to prevent overheating.

31. Never install the radiant heater in a position where it can fall into a bathtub or another vessel containing water.

32. The radiant heater should not be placed next to or on items or objects which are flammable or can melt, for example, wood, straw, curtains, furniture, bedding, clothing, paper, plastics, etc.



33. Do not use the appliance in areas where petrol, paint or other flammable liquids are stored.

34. The radiant heater becomes hot during use. To prevent burns, do not let bare skin touch the appliance.

Warning: The heater is not equipped with a controller to regulate the room temperature.

35. Always grab the radiant heater by the stand if you want to move it, and let it cool down beforehand.

36. If the heating element is touched, remove any fingerprints with a soft cloth and an alcohol-based cleaning agent. Burnt-on dirt can cause malfunctions.

37. Do not operate the radiant heater with wet or damp hands.



38. People with reduced sensitivity to heat are not recommended to use the appliance.

39. Extreme caution is necessary when the heater is used by or near children or impaired persons, or when the heater is left operating and unsupervised.

40. Do not leave the radiant heater unsupervised when it is switched on. Unplug the radiant heater when it is not in use.

41. If the appliance has visible signs of damage, it may no longer be used.



<p>ATTENTION</p> 	<p><u>RISK OF INJURY</u></p> <p>This appliance becomes hot during use.</p> <p>Never touch the appliance while it is in use → this may result in severe BURNS.</p>
<p>ATTENTION</p> 	<p><u>RISK OF FIRE</u></p> <p>Do not cover the appliance while it is in use.</p>
<p>ATTENTION</p> 	<p><u>SAFE DISTANCE</u></p> <p>Maintain a safe distance of at least one metre from flammable items such as furniture, curtains, paper and similar.</p> <p><u>PLACE OF USE</u></p> <p>Position the appliance in such a way that air can flow in and out without hindrance.</p> <p><u>RISK OF BURNS</u></p> <p>This appliance becomes very hot during use and can cause burns. Take particular care if children or vulnerable persons are present.</p> <p><u>RISK OF OVERHEATING</u></p> <p>Do not use the appliance in rooms with a volume less than 4m³.</p>

Symbol markings on the appliance

Symbol:





Meaning:

Attention! Do not cover The symbol on the device indicates that it is not permitted to suspend any item (e.g. towels, clothing etc.) above the appliance or directly in front of it. To prevent overheating and the risk of fire, the heater must not be covered.



Recycling, disposal and Declaration of Conformity

	<p><u>RECYCLING</u></p> <p>The packaging materials can be recycled. It is recommended that you dispose of them in separated waste.</p>
	<p><u>DISPOSAL</u></p> <p>The pictogram with the crossed out dustbin indicates that electrical and electronic appliances must be disposed of separately from household waste (WEEE). Electrical and electronic appliances can contain harmful and environmentally hazardous materials. Do not dispose of them in unsorted residual waste, but at a registered collection centre for waste electrical and electronic equipment. By doing so, you will help to conserve resources and protect the environment. For further information please consult your dealer or your local authorities. Directive 2012/19/EU</p>
	<p><u>DECLARATION OF CONFORMITY</u></p> <p>We hereby confirm that this article complies with the essential requirements, regulations and guidelines of the EU. The detailed declaration of conformity can be viewed at any time via following link:</p> <p>https://www.schuss-home.at/downloads</p>

Errata and technical changes reserved.



Scope of delivery

- Radiant heater
- Operating manual

Description of the appliance

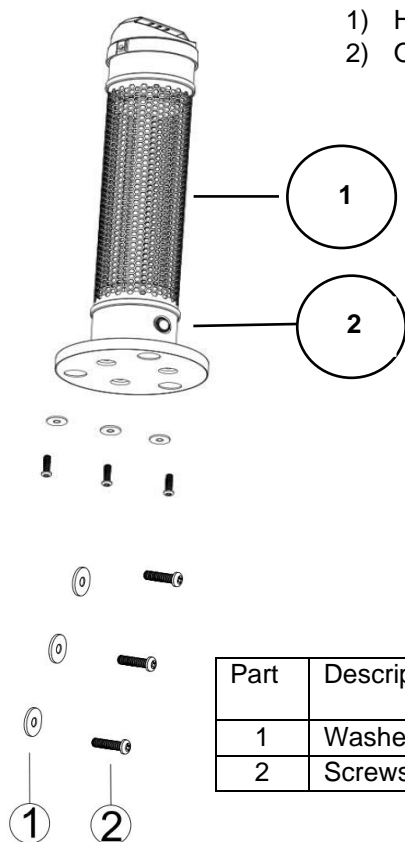

Part	Description	Specifications	Quantity
1	Washer	Ø20*2.mm	3 pcs.
2	Screws	M6*25mm	3 pcs.

Check that the screws are tight two weeks after installation, and every three months thereafter, and tighten them if necessary.



Place of use and connection to power supply

The appliance must be disconnected from the power supply before it can be assembled. Place the appliance on level ground at least one metre away from other surfaces and flammable materials.



ATTENTION

Certain parts of this appliance may become very hot and cause burns.

Starting up and functions

- Insert the plug into an earthed power socket and switch the appliance on with the toggle switch.
- The toggle switch on the left controls the heating element. When the heating element is switched on, the appliance provides 800 watts of heating power.



ATTENTION

Do not place any objects on the radiant heater such as clothing or towels.

Do not use this appliance in close proximity to bathtubs, showers or other vessels containing water.

When in operation, the housing of the appliance is hot!

Avoid any bodily contact with the appliance while it is on as this may cause severe injuries. Always allow the appliance to cool down before moving it.

Safety features

The fan heater features tip protection that switches the appliance off if it should fall over unexpectedly. When you stand it up again, it resumes operation.

But to do this, first switch the appliance off, remove the plug from the power socket and check the fan heater for any damage. Do not use the appliance if it is damaged or does not function correctly. Take it for inspection and if necessary for repair.

Cleaning and maintenance



Only the exterior of the appliance requires periodic cleaning.

- Before cleaning, unplug the appliance from the power supply and wait until it has cooled down completely.
- Clean dust from the grilles.
- Clean the appliance with a moderately damp cloth. Never use strong or abrasive detergents, scouring pads or steel wool as these will damage the appliance.

When the appliance reaches the end of its useful life, do not dispose of it in the household waste. Instead, it must be taken to a collection point for the recycling of domestic electrical and electronic appliances.

TECHNICAL INFORMATION

Article number:	SHX49HEAT2022
Input voltage:	220-240 V
Frequency:	50-60 Hz
Rated power consumption:	800 W
Controllable parameters:	On-Off
Protection class:	IP44
Weight:	2.8 kg
Dimensions	200 × 200 × 610 mm
Contact address for further information:	Schuss Home Electronic GmbH Scheringgasse 3, A-1140 Vienna, Austria Serviceline: +43 (1) 97 0 21 www.schuss-home.at / www.shx.at FB no.: 236974 t / FB court: Vienna