

Download the Nordlux Smart Light app from the App Store or Goggle Play.

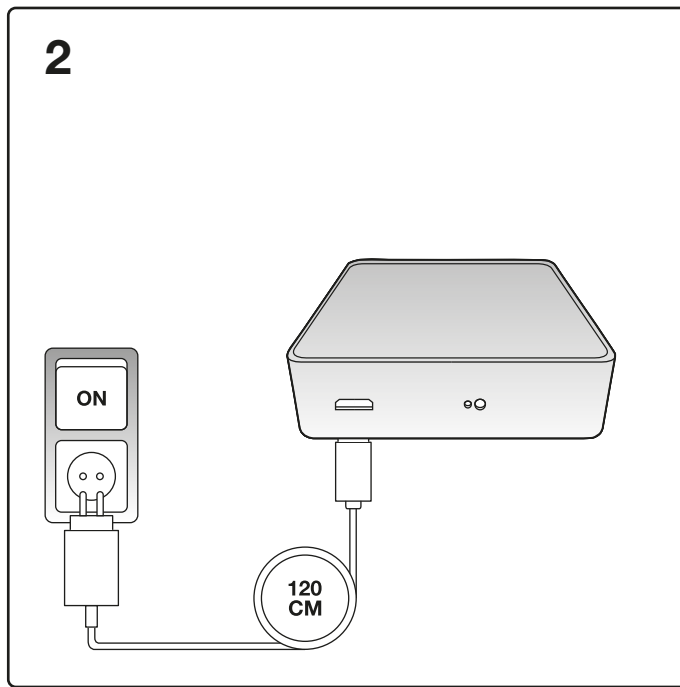

Connect your Nordlux Smart Light Bridge – remember to turn on the light switch.

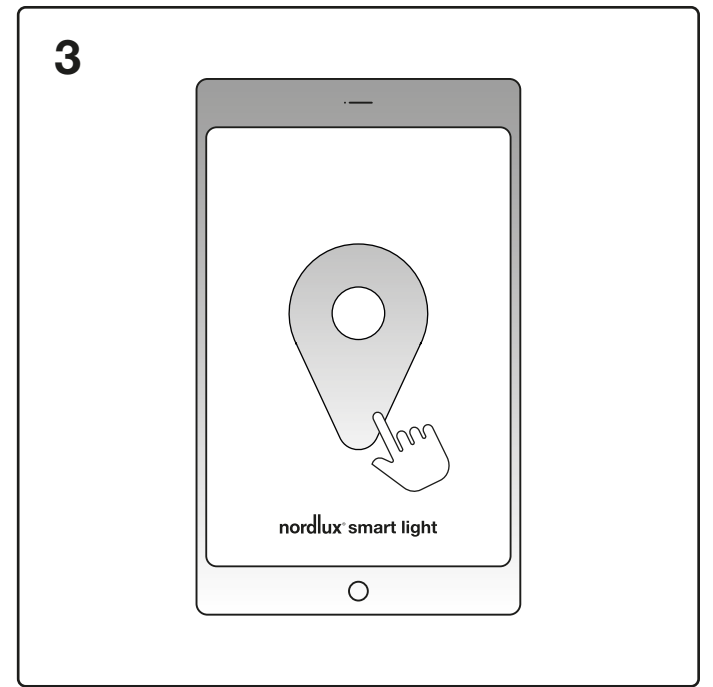

Select access to the unit's placement in the Nordlux Smart Light app.

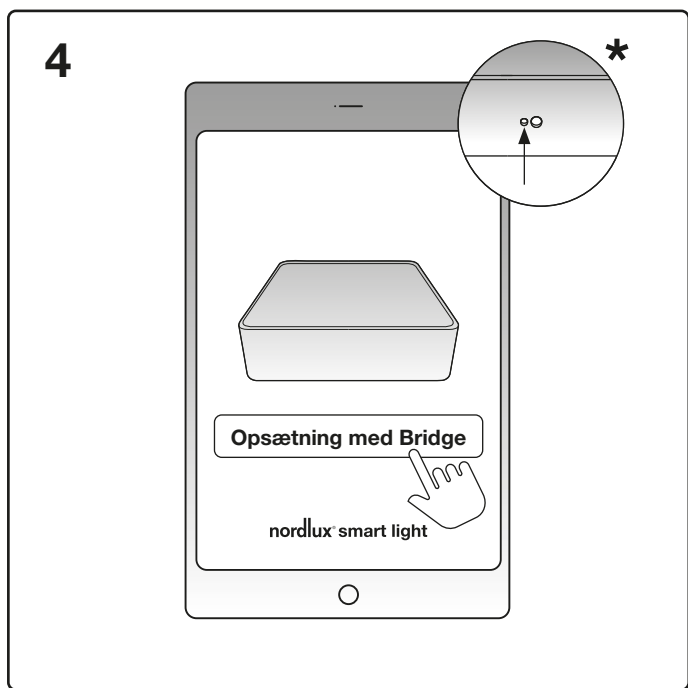

Select 'Setup with Bridge' in the Nordlux Light app.

*If the bridge does not show in the Nordlux Smart Light app, it can be reset by sticking a pointed object in here.

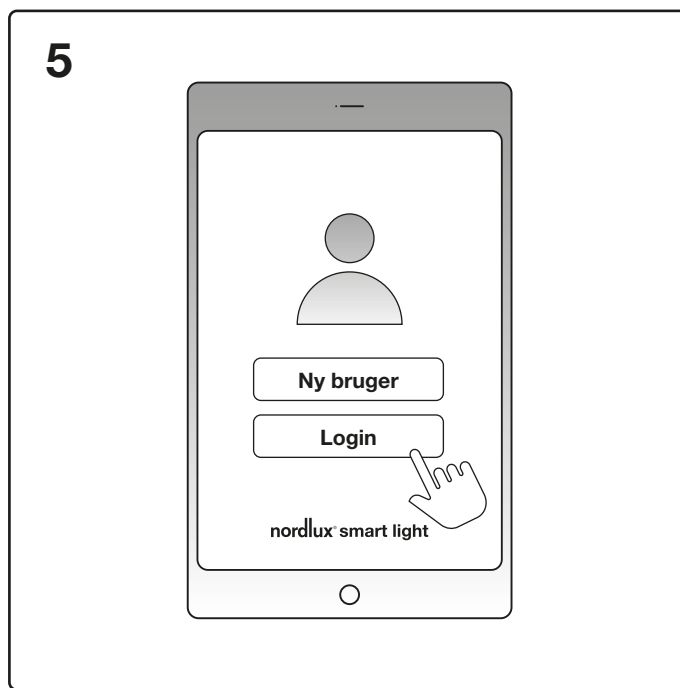

Create a new user or login if you are already a user.

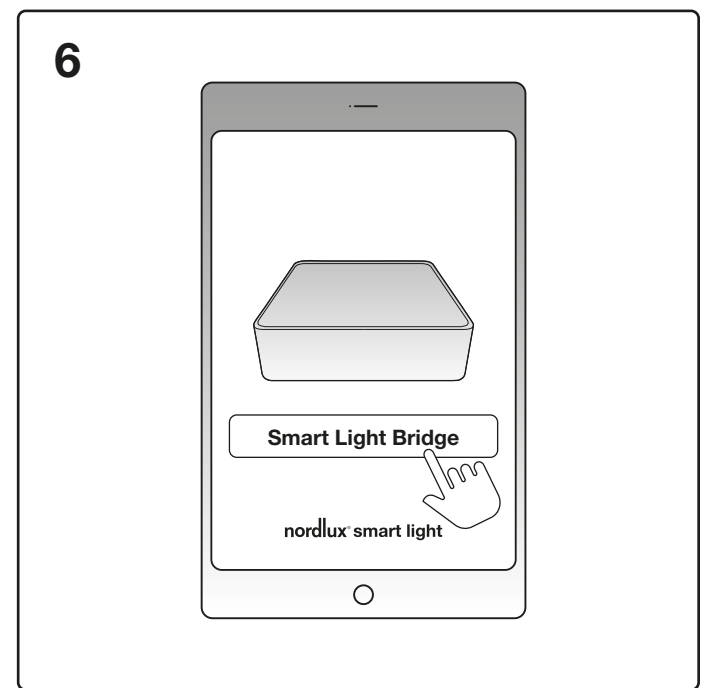

Select 'Smart Light Bridge' by pressing the button saying 'Smart Light Bridge'

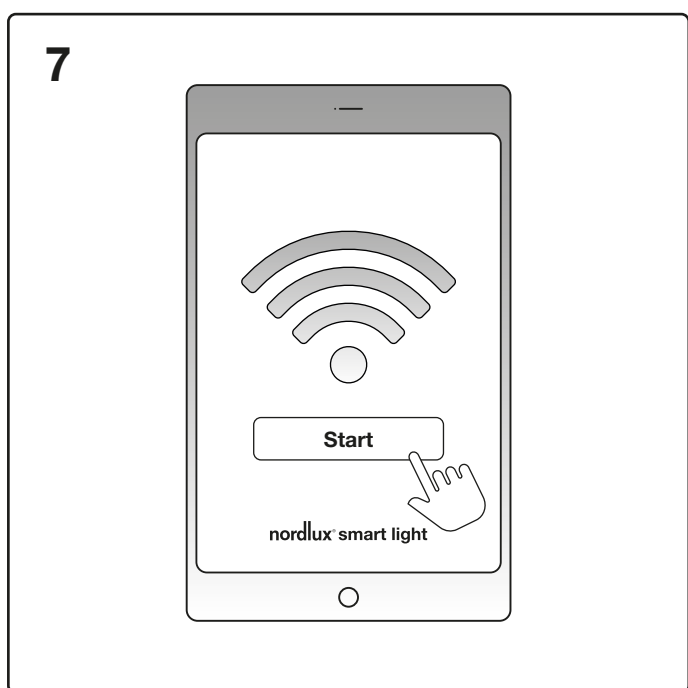

Connect to your Wi-Fi. It is important that the selected Wi-Fi is only 2.4GHz. Nordlux Smart Light Bridge only works with 2.4GHz. Select 'Start'.

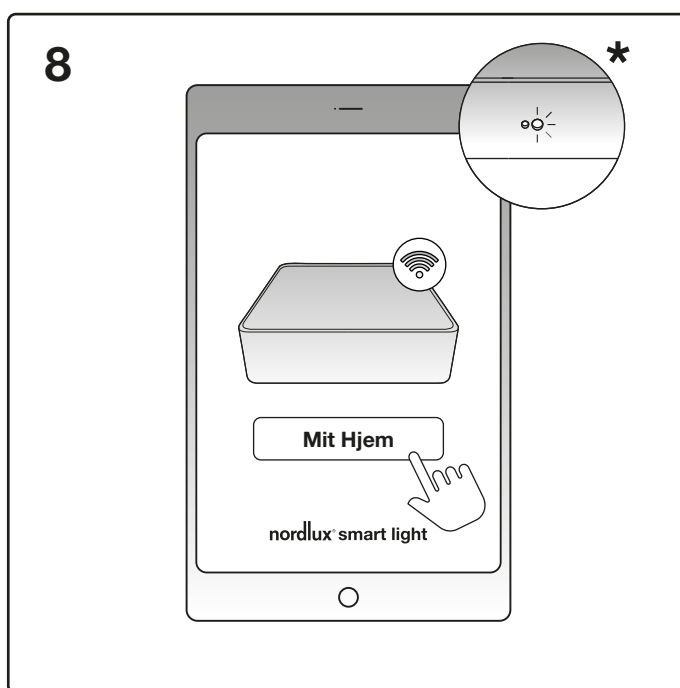

Smart Light Bridge is installed*. Select 'Go to my home'.

*If the light on the back of the Smart Light Bridge is flashing, it means that a connection is established.

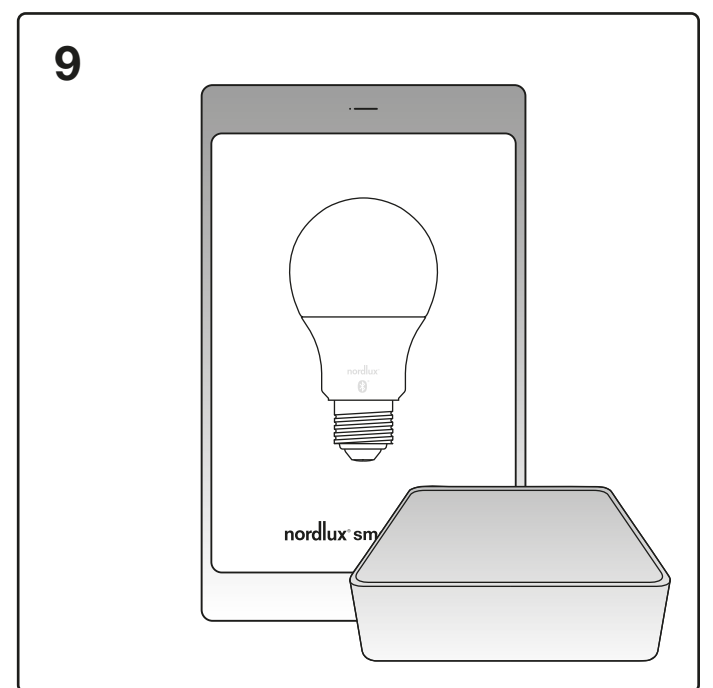

The installation is completed. You can now use your Smart Light Bridge. Enjoy.

START SMART

nordlux[®]
<https://www.nordlux.dk/produkter/smart-belysning>