

DE

EN

NL

FR

IT

ES

PL

CS

SV

**HOME
PILOT**

Kurzanleitung

Gurtwickler ROLLOTRON

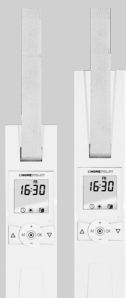

ROLLOTRON
premium



ROLLOTRON
pure

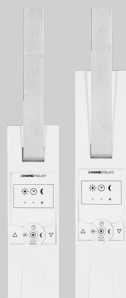

ROLLOTRON
classic





Sicherheitshinweise

Bitte die Sicherheitshinweise vor der Montage beachten.



Lebensgefahr durch Stromschlag



Gefahrenstelle / gefährliche Situation



GEFAHR!

Diese Gefährdung wird zu schweren Verletzungen oder zum Tode führen.



WARNUNG!

Diese Gefährdung kann zu schweren Verletzungen oder zum Tode führen.



VORSICHT!

Diese Gefährdung kann zu geringfügigen bis mittelschweren Verletzungen führen.



ACHTUNG!

Diese Gefährdung kann zu Sachschäden führen.

Diese Kurzanleitung ist nur ein Bestandteil des kompletten Benutzerhandbuchs. Für eine sichere Handhabung des Produktes ist es erforderlich, das gesamte Handbuch zu lesen. Dieses ist auf unserer Homepage verfügbar:

<https://service.homepilot-smarthome.com>



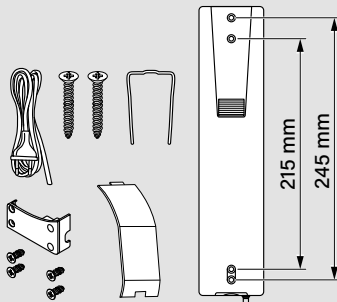
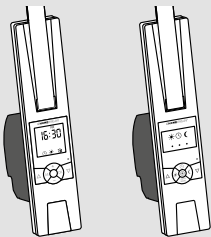
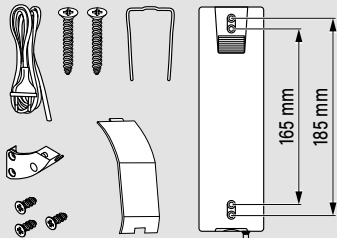
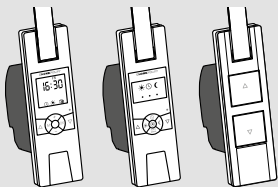

1

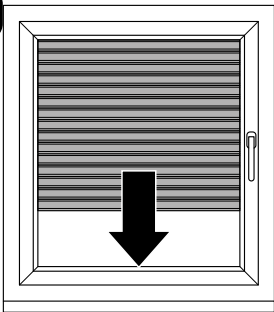

2

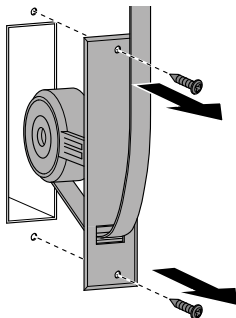

3

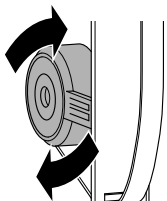

4

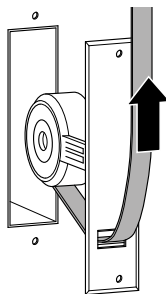
**VORSICHT!**

Durch die vorgespannte Feder des alten Gurtwicklers besteht Verletzungsgefahr.

5

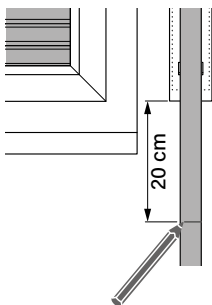

6

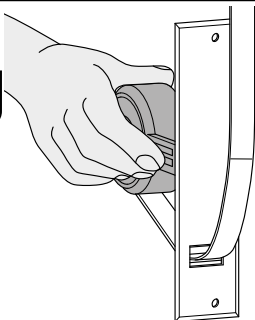

7

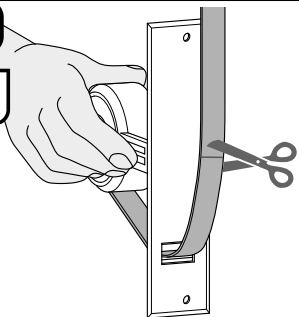

8

SLOW

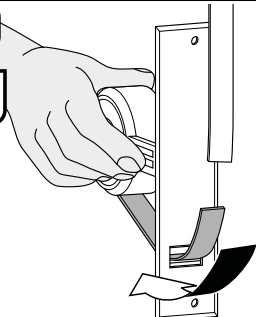

9

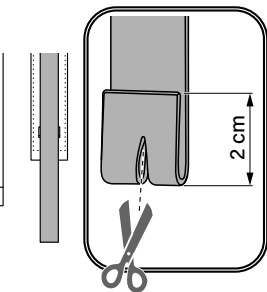

10

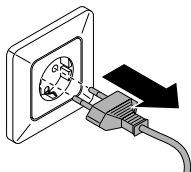
**GEFAHR!**

Montage- und Anschlussarbeiten stets im spannungslosen Zustand durchführen!

11

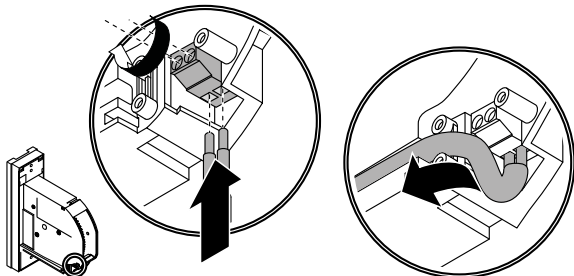

12

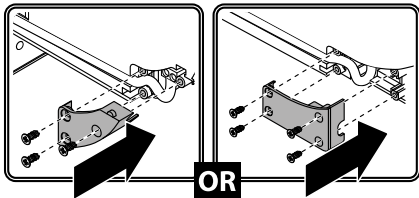

OR

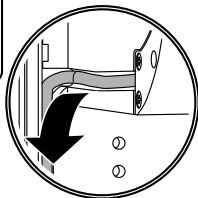
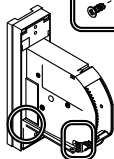

13

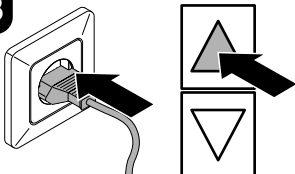
**VORSICHT!**

Nicht bei laufendem Motor in das Wickelradfach fassen!

14

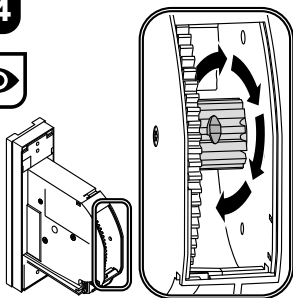

15

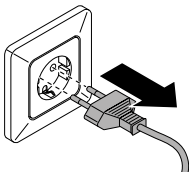
**WARNUNG!**

Vor dem Hineinfassen in das Wickelradfach immer den Netzstecker ziehen!

16

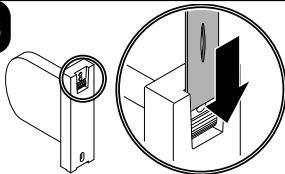
**ACHTUNG!**

Das Gurtband muss gerade und leicht laufen, Verdrehungen sind zu vermeiden. Bei schwergängigen Rollläden wird empfohlen eine Umlenckrolle an den Gurtkasten zu montieren.

17

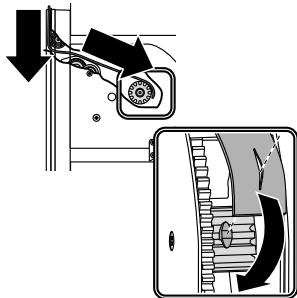

18

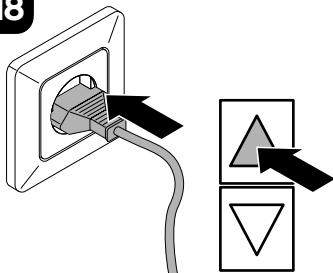

19

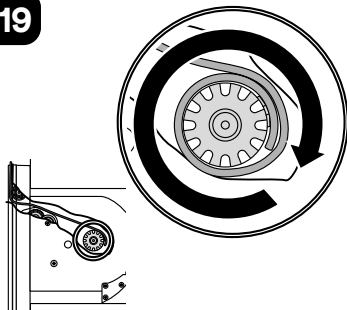

20

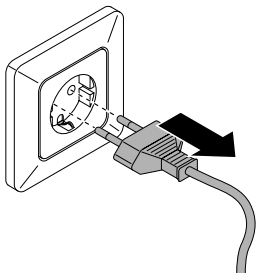

21

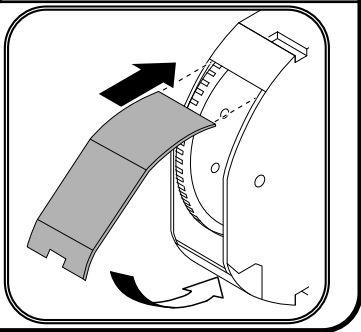
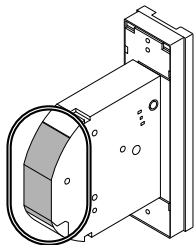

22

**WARNUNG!**

Kurzschlussgefahr durch beschädigtes Anschlusskabel. Das Anschlusskabel beim Anschrauben des RolloTron nicht quetschen oder beschädigen!

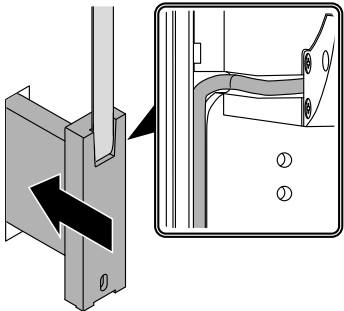

23

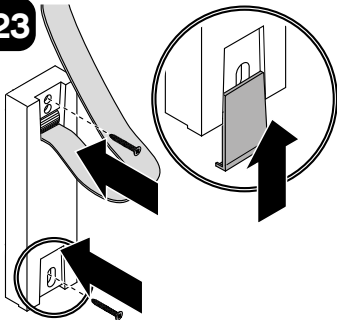

24

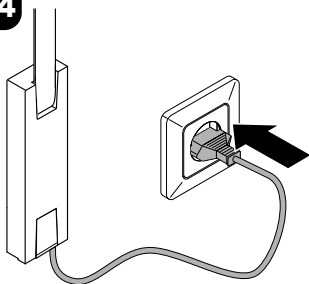

25

**ACHTUNG!**

- Zur vollständigen Funktionalität muss der obere und untere Endpunkt eingestellt werden. Sonst kann es zu Funktionsstörungen kommen.
- Bitte beachten: die falsche Einstellung der beiden Endpunkte kann zur Überlastung bzw. Zerstörung des Antriebs führen. Daher den oberen Endpunkt nicht ganz bis zum Anschlag einstellen! Die Tasten dabei rechtzeitig loslassen und nicht über den jeweiligen Endpunkt hinausfahren!

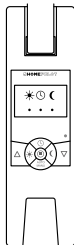
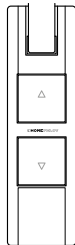
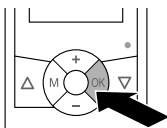
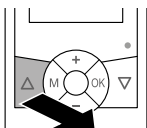
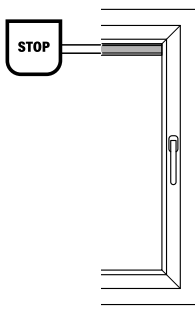
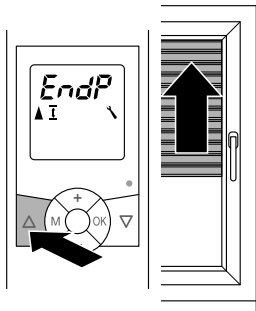
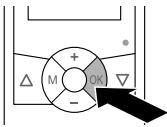
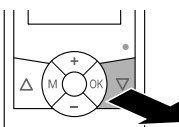
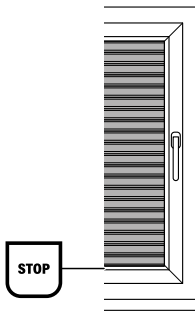
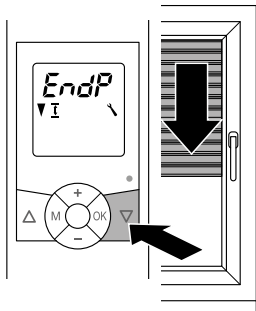
A**B****C****A1****A2**

A3

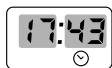

+



+

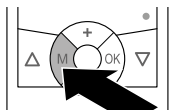
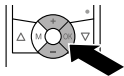
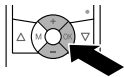
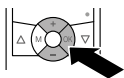

2 sec. ✓

B1

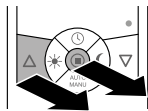
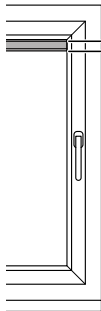
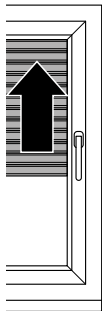
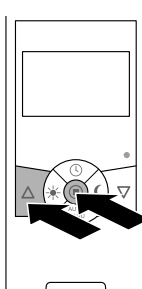

B2

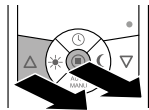
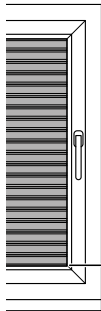
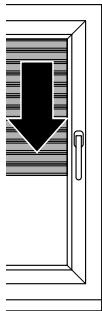
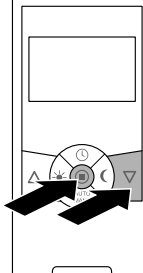

C1

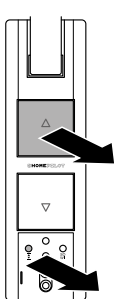
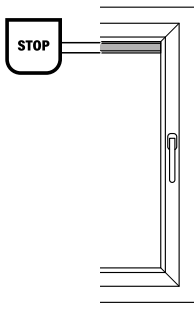
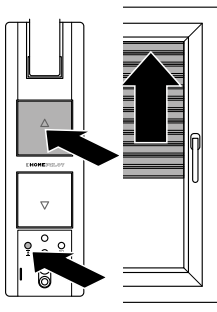

C2

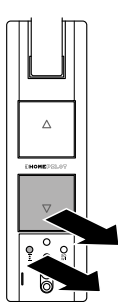
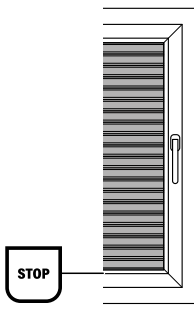
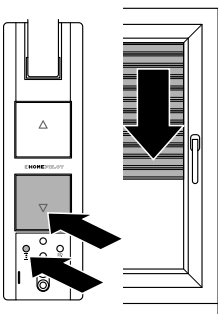



KONTAKT

via Email: service.de@homepilot-smarthome.com
service.at@homepilot-smarthome.com
service.ch@homepilot-smarthome.com

RADEMACHER

Geräte-Elektronik GmbH
Buschkamp 7
46414 Rhede (Deutschland)