

Klingeltaster / Push button Combilux

Installation



D Montage muss im spannungslosen Zustand durch eine Elektrofachkraft erfolgen!

GB Installation must be carried out in deenergized condition by an electrical!

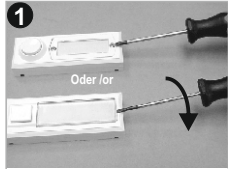

1
Gehäuse öffnen
Open the casing

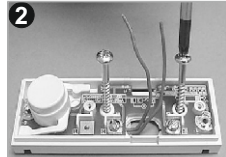

2
Festschrauben (Dist. 32mm)
Wall fixation (Dist. 32mm)

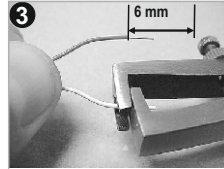

3
Drähte absolieren (6mm)
Strip the wires (6mm)

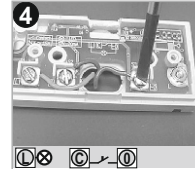

4
Drähte anschließen
Connect wires

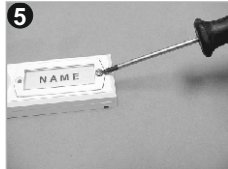

5
Namensschild einlegen, schließen
Insert name plate, close cover

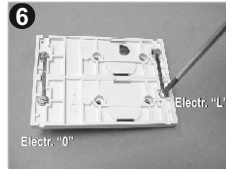

6
Anruehrung mehrerer Taster
Combinat. several pushes

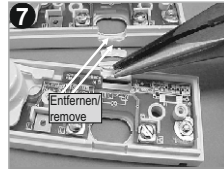

7
2 Stge im Unterteil entfernen.
Remove 2 ribs in the base

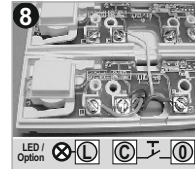

8
Drähte anschließen etc.
Connect wires etc.

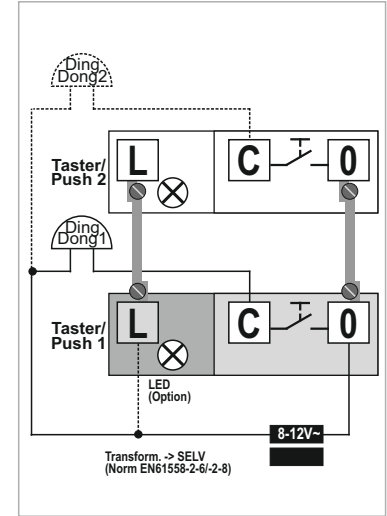

Technische Daten / Technical data

* 8 - 12 V ~ (AC 5 mA - 1,5 A)

* 8 - 12 V = (DC 5 mA - 1,0 A)

* LED: 8 - 12 V~ (AC 0,02 A)

* Nur Schutzkleinspannung! Protect. low volt. only!

* Leiter/Wire 0,6 - 0,8 mm

* -20°C...60°C

* IP41

* Druckkraft/Op. force ca. 6 N



Grothe GmbH
Löhestraße 22
53773 Hennef
service@grothe.de

GROTHE
URMET|GROUP