

**FCJJ-34**



**+ ADD-ON**

**FCJJ-24**

**HORIZON ENERGY MONITOR**

This ideal accessory to FCJJ-34 feeds live experiment data to your PC to be displayed as graphical data.

## Product Description

The Salt-water Fuel Cell Science Kit illustrates a cutting edge fuel cell concept: combine a saltwater electrolyte with magnesium plates to generate electrical energy. The Salt Water Fuel cell kit enables you to investigate the science behind salt water fuel cell technology, either by powering the included mini-turbine or creating your own power applications.

## Features



- ✓ Features magnesium salt-water fuel cell power device
- ✓ Develop your own micro-fuel cell applications
- ✓ Easy to integrate and use
- ✓ Compatible with other Horizon science kits

## Language Pack

- ✓ Assembly Guide :
- ✓ Technical Support Guide:

## Experiments & Activities

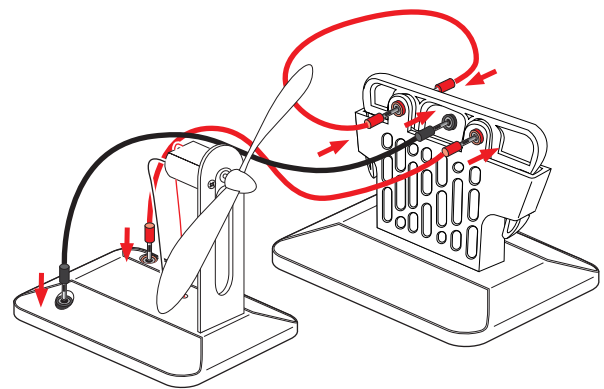

### ✓ Salt water energy experiments

1. Create energy from salt water solution and power a fan
2. Analyze current and voltage variation using different salt concentrations
3. Analyze current and voltage variations using different temperatures
4. Analyze current and voltage variations using different fuel volumes



## Kit Content

- ✓ Salt water fuel cell
- ✓ Salt water fuel cell anode plate
- ✓ Fan module
- ✓ Salt water fuel cell base
- ✓ Fan blade
- ✓ Gradual container
- ✓ Wires
- ✓ Fan blades adapter
- ✓ Syringe and its tube
- ✓ Renewable Energy Curriculum CD

## Certification

ROHS, EN71:PART1;PART2;PART3, EN62115, PHTH-EU, ASTM F963, CPSIA-LEAD, CPSIA-PHTHALATES, REACH, CA.

\*All the information in this datasheet is subject to change without notice. In case of doubt please contact the Horizon sales team.

## Packing Information

<b>Case Pack Quantity</b> (units):	1
<b>Master Pack Quantity</b> (units):	24
<b>Packaging Type:</b>	cardboard
<b>20' Container</b> (units):	6550
<b>40' Container</b> (units):	13355
<b>Unit Box Length</b> (cm/in):	20.9 / 8.23
<b>Unit Box Width</b> (cm/in):	15 / 5.91
<b>Unit Box Height</b> (cm/in):	10.3 / 4.06
<b>Unit Volume</b> (Litres/Cubic Meters):	3.2 / 0.003
<b>Unit Box Weight</b> (kg/lbs):	0.36 / 0.79
<b>Case Pack Length</b> (cm/in):	63 / 24.80
<b>Case Pack Width</b> (cm/in):	44 / 17.32
<b>Case Pack Height</b> (cm/in):	35 / 13.78
<b>Case Pack Volume</b> (Litres/Cubic Meters):	97.0 / 0.097
<b>Case Pack Weight</b> (kg/lbs):	9.6 / 21.16

\*The cartons' size may vary between ±1-2 cm.

## Logistics Information

<b>Item UPC-Code:</b>	6942503405293
<b>Item HS-Code:</b>	-
<b>Manufactured in:</b>	Shanghai, China
<b>Local Warehouse</b>	Prague, Czech Republic
<b>FOB Harbor:</b>	Los Angeles, USA
<b>First Ship Date:</b>	available now
<b>Minimum Order:</b>	24