

START

1

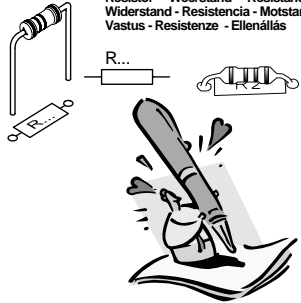

Resistor - Weerstand - Résistance - Widerstand - Resistencia - Motstand - Vastus - Resistenze - Ellenállás

◇ R1, R2 : 100

◇ R3 ... R6 : 1K

◇ R7, R8 : 10K

◇ R9 ... R12 : 100K

◇ R13 : 150

◇ R14 : 470

(Barna, fekete, barna) (Brown, Black, Brown) - (Bruin, zwart, Brown) - (Brun, noir, Brun) - (Braun, Schwarz, Braun) - (Brun, Svart, Brun) - (Ruskea, Musta, Ruskea) -

(Barna fekete piros) (Brown, Black, Red) - (Bruin, Zwart, Rood) - (Brun, Noir, Rouge) - (Braun, Schwarz, Rot) - (Brun, ...)

(Barna fekete narancssárga) (Brown, Black, Orange) - (Bruin, Zwart, Oranje) - (Brun, noir, Orange) - (Braun, Schwarz, Orange) - (Brun, Svart, Orange) -

(Barna fekete sárga) (Brown, Black, Yellow) - (Bruin, zwart, Geel) - (Brun, noir, Jaune) - (Braun, Schwarz, Gelb) - (Brun, SvartAmarelo) - (Marrone, Nero, Giallo)

(Barna zöld barna) (Brown, Green, Brown) - (Bruin, Groen, Bruin) - (Brun, Vert, Brun) - (Braun, Grün, Braun) - (Brun, Grün, Brun) - (Ruskea, Vihreä, Ruskea) - (

(Sárga, biolya, barna) (Yellow, Purple, Brown) - (Geel, Paars, Bruin) - (Jaune, Violet, Brun) - (Gelb, Violet, Braun) - (Gul, Lila, Brun) - (Keltainen, Purppura, Ruskea) - (Amarillo, Morado, Marrón) - (Amarelo, Violeta, Castanho) - (Giallo, Viola, Marrone) - (Gul, Violet, Brun)

2

Dióda

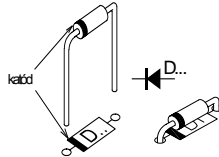

◇ D1 : 1N4148

3

Kondenzátor

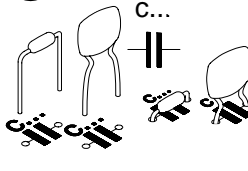

◇ C5 ... C7 : 100nF (104)
◇ C8 : 3n9 (392)

4

IC foglalatok

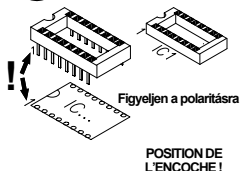

◇ IC1 : 14p
◇ IC2 : 18p

5

TRIMMER

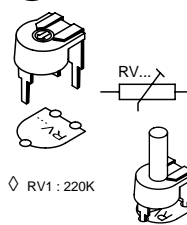

◇ RV1 : 220K

6

LED'S

Figyeljen a polaritására!
Attention à la polarité !

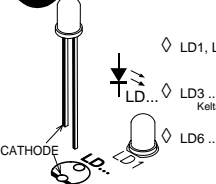

◇ LD1, LD2 : Red, Rood, Rouge, Rot, Röd, Punainen, Rojo, Encarnado, Rosso, piros

◇ LD3 ... LD5 : Yellow, Geel, Jaune, Gelb, Gul, Keltainen, Amarillo, Amarelo, Giallo, sárga

◇ LD6 ... LD10 : Green, Groen, Vert, Grün, Grön, Vihreä, Verde, zöld

7

Tranzistor

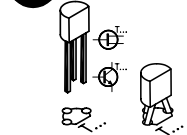

◇ T1 : BC557
◇ T2 : BC547

8

Feszültség szabályozó

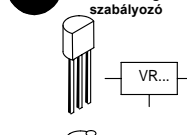

◇ VR1 : UA78L05

9

Kapcsoló

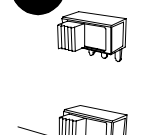

◇ SW1

11

Zűmmer

Figyeljen a polaritására
Attention à la polarité !

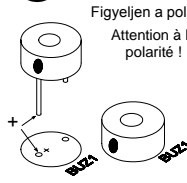

◇ BUZ1

12

IC'k

Figyeljen a polaritására

OF THE NOTCH!
ATTENTION A LA POSITION DE L'ENCOCHE!

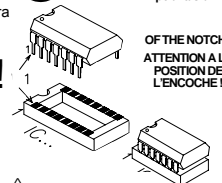

◇ IC1 : LM324
◇ IC2 : LM3914N

13

Elektrolit kondenzátor

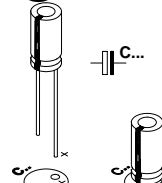

◇ C1 ... C4 : 100µF

14

Elemtartó

Elemtartó

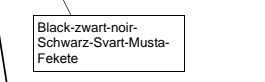
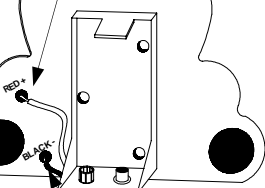
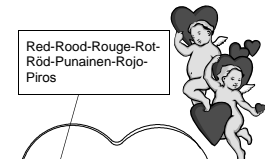
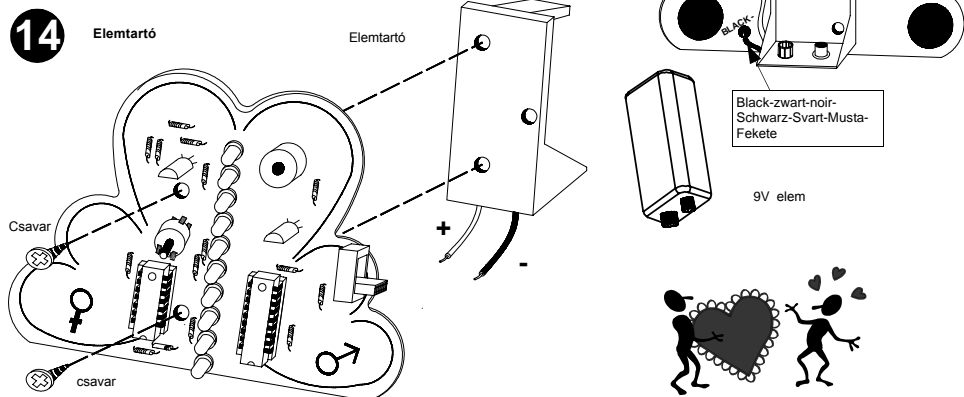

9V elem

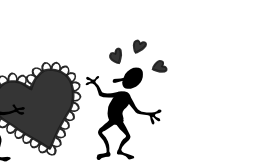

Vázlatos ábra

