

Slim DisplayPort KVM over IP Extender (Transmitter) KE9900ST

- The KE9900ST Slim DisplayPort KVM over IP Extender is a compact and affordable high performance IP-based transmitter which can be paired with any KE Series* receiver for a savings solution that stays within budget. The KE Series* extenders allow access to a computer system from a remote USB console over an intranet, enabling users to locate computers in a secure and temperature controlled environment, which is isolated from users' workstation.

The KE9900ST supports DisplayPort video input from the computer while the paired KE Series receiver supports DisplayPort, DVI or HDMI monitor output, providing video resolutions up to 1920 x 1200 and flawless and lossless video compression quality with minimal latency. The extender also supports RS-232 serial commands. In addition to a DC power jack, the KE9900ST transmitter includes an extra DC terminal block for convenient installation.

The KE9900ST can be set on a desk, mounted on a wall or at the rear of a rack with its space-saving 0U rack mount design. Moreover, the KE9900ST can be used as a point-to-point/point-to-multipoint/multipoint-to-point extender, or integrated into a KVM over IP Matrix System (multipoint-to-multipoint) when combined with the KE Matrix Management Software (CCKM), providing more flexible applications in different working environments.

The KE9900ST can be configured through the KE Matrix Management Software or RS-232/Telnet text menu. The KE extender also offers enhanced security features such as supporting AES encryption for secured Video/Keyboard/Mouse/USB data transmissions and RADIUS/LDAP/AD or remote user authentication that provides an added layer of connection security.

When integrated with the KE Matrix Management Software and paired with the KE Series receiver, the KE extender supports more advanced features such as boundless switching, fast switching, video wall, multi display, profile scheduling, auto detection of all KE Series extenders on the same subnet for the sake of fast installation or configuration, as well as username/password authentication and authorization. Please refer to the CCKM webpage for more details.

Whether you're configuring, monitoring, administrating, controlling or extending computer access, the KVM over IP Matrix System is made adaptable, to fit an endless variety of working environments and workstation settings, as well as to provide solutions in broadcasting, control center, multimedia, manufacturing and many other industries where matrix extending is required.

*Please visit www.aten.com for a comprehensive list of KE Series Extenders.

KE9900ST Front View



KE9900ST Rear View



Features

Hardware

- Advance processor provides lossless and low latency video transmissions up to 1920 x 1200 @ 60Hz; 24-bit color depth
- Support standard DisplayPort resolutions from 640 x 480 up to 1920 x 1200
- Compliant with DP 1.2 and HDCP 1.3
- Auto-MDIX – automatically detects cable type
- Built-in 8KV/15KV ESD protection and 1KV surge protection
- Slim, light and fanless design for silent operations that are energy efficient
- Support connection via Gigabit Ethernet port
- Rack Mountable* and Wall Mountable
- Mounting options:
 - VE-RMK 1U Extender Rack Mount Kit*

Note: *Refer to www.aten.com for more regarding the VE-RMK 1U Extender Rack Mount Kit.

Management

- EDID Expert™ – selects optimum EDID settings for smooth power-up and highest quality display
- On-screen Preview – allows users to view the video of up to 36 displays on one screen
- Video Compression Level – allows you to increase/decrease the video quality to adjust for appropriate network bandwidth
- CLI – administrators can control all KE devices via RS-232 or Telnet by issuing commands
- RS-232 serial ports – allow you to connect to a serial terminal for text menu, CLI, or serial devices such as touch screens and barcode scanners
- Compatible with all KE devices

Security

- Dedicated LAN port for KE direct connections – can be isolated from the corporate network
- Secure data transmission – AES encryption to secure Video/Keyboard/Mouse/Data transmission
- Supports industry standard Transport Layer Security (TLS) protocol

Virtual Media

- Virtual Media enables file transfers, OS patching, software installations and diagnostic testing
- Support USB 2.0 DVD/CD drives, USB mass storage devices, PC hard drives and ISO images
- Support Smart Card/CAC Reader

Advanced Features**

- Flexible connections – allows multiple extender and matrix connections for multi-display installations and video wall applications
- “Push” and “Pull” – share content instantly by just one click
- Fast Switching – switch between different remote video resolutions on a local display within 0.3 second
- Boundless Switching - simply move the mouse cursor across screen boundaries to switch between different receivers
- Video Walls – create multiple video walls with up to 8 x 8 (64 displays max.) in each layout
- Advanced Scheduling – improves efficiency and saves costs by allowing connections to be set based on time and date
- Virtual Transmitter – to stream video, audio, USB, and serial sources independently
- Support both internal and external authentication – external authentication supports LDAP, Active Directory, RADIUS and TACACS+
- Advanced User Authorization Settings – administrators can set four access modes of permissions on Tx devices for collaboration or to avoid interference among users
- Configurable user and group permissions for access and control of KE devices
- Tx grouping of up to 4 sets of KE transmitters to support multi-display applications

Note: **These advanced functions are supported when the KE transmitters are paired with KE receivers and managed by KE Matrix Management Software (CCKM).

Highlights

Over IP	Extend a computer's KVM console any distance over a LAN by connecting the Tx and Rx units to your network. Extend a computer's KVM console up to 100 meters by directly connecting the Tx and Rx units with a single Cat 5e/6 cable. Standard IP protocols ensure maximum compatibility with your existing IT infrastructure and staff skill set.
Flexibility	The KE extender allows you to access, share, and switch full control of Tx connected computers - from any Rx (KVM console) on the network. Flexibly allows One-to-One, One-to-Many, Many-to-One, or Many-to-Many computer to KVM console connections.
Superior Video Quality	ATEN's advanced graphics processor delivers video that ensures you to experience the same vivid and sharp quality on the remote monitor no matter how far away the console is located.

Enhanced Security	Compliant with universal enterprise grade security standards (AES encryption to secure Video/Keyboard/Mouse/Data transmission and Transport Layer Security (TLS) protocol). The KE extender provides different levels of username/password authentication and authorization.
Advanced Management System	The KE Matrix Management Software allows you to easily administer all KE devices over a network, using an intuitive user-friendly web based GUI.
Fast Switching*	Fast switching feature allows switching between the TX devices within 0.3 second. Users can operate keyboard / mouse immediately without waiting for the process of USB enumeration. This is ideally for control center application, which has strong demand for the seamless operation.
Boundless Switching*	Simply move the mouse cursor across screen boundaries to switch between different receivers. The function expedites the process of switching between receivers for a smooth and hassle-free user experience and enables immediate monitoring and management of receivers.

Note: *These advanced functions are supported when the KE transmitters are paired with KE receivers and managed by KE Matrix Management Software (CCKM)

KE9900ST Diagram

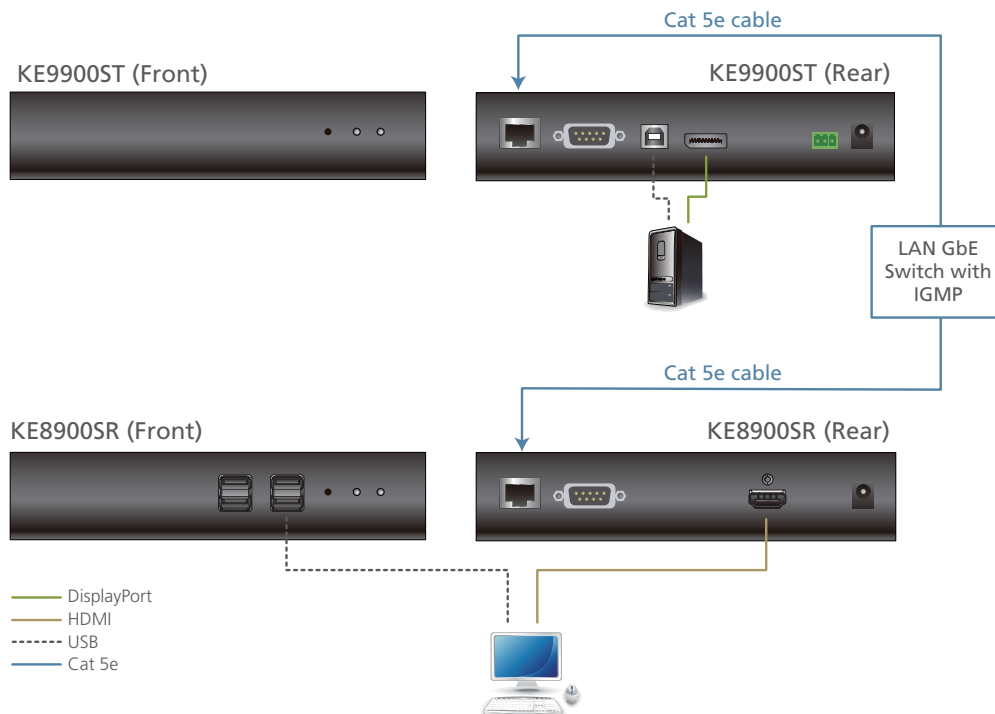

Reference Installation Diagram

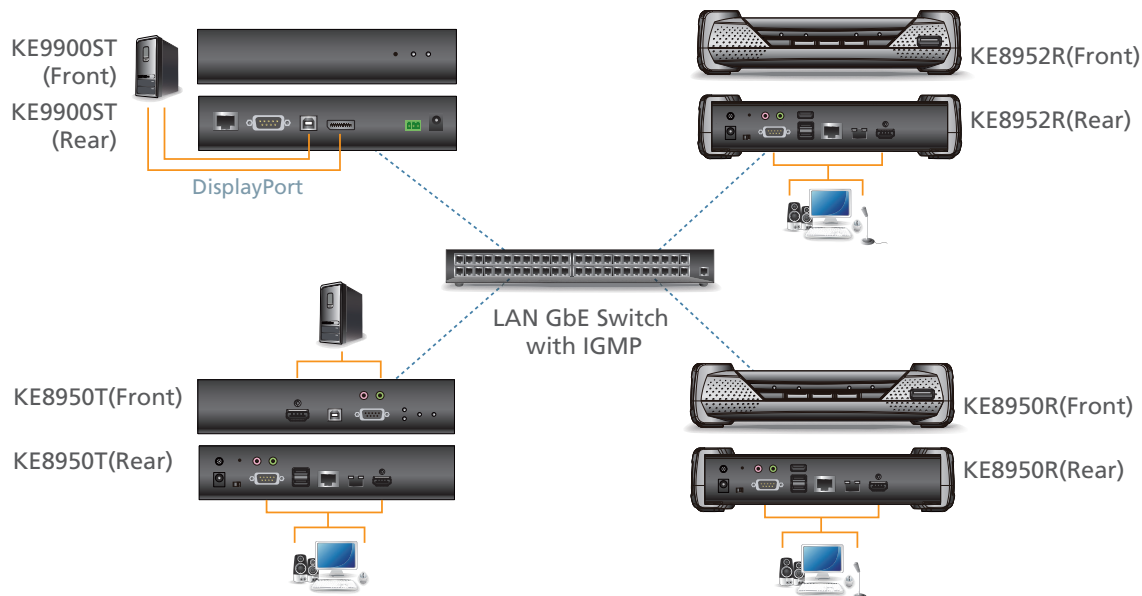

Specifications

Function	KE9900ST
Connectors	
KVM Ports	1 x USB Type B Female (White)
	1 x DisplayPort Female (Black)
	1 x DB-9 Female (Black)
Power	1 x DC Jack (Black)
	1 x 3-Pole Terminal Block Connector (Green)
LAN Ports	1 x RJ-45 (Black)
Switches	
Reset	1 x Semi-recessed Pushbutton
LEDs	
10/100/1000 Mbps	1 (10: Orange / 100: Orange & Green / 1000: Green)
Power	1 (Blue)
Emulation	
Keyboard / Mouse	USB
Power Consumption	
	DC 5V / 4.75W; DC 48V / 6.97W
Video Resolution	
	Up to 1920 x 1200 @ 60Hz
Environmental	
Operating Temperature	0° - 50° C
Storage Temperature	-20° - 60° C
Humidity	0 - 95% RH, Non-condensing
Physical Properties	
Housing	Metal
Weight	0.65 kg
Dimensions (L x W x H)	18.20 x 11.75 x 2.87 cm

Product information is subject to change without prior notice.

ATEN International Co., Ltd.

3F., No.125, Sec. 2, Datong Rd., Sijhih District., New Taipei City 221, Taiwan
 Phone: 886-2-8692-6789 Fax: 886-2-8692-6767
 www.aten.com E-mail: marketing@aten.com

Publish Date: 11/2018 V1.0



© Copyright 2018 ATEN® International Co., Ltd.
 ATEN and the ATEN logo are trademarks of ATEN International Co., Ltd.
 All rights reserved. All other trademarks are the property of their respective owners.